

An aerial photograph of a desert oasis. In the center, a circular pond with clear, light blue water is surrounded by a dense cluster of palm trees and other green vegetation. The surrounding landscape is a vast, undulating desert of golden sand dunes, with long shadows cast across them, suggesting a low sun position. The sky is a pale, hazy blue, and the overall atmosphere is one of serene isolation.

LUCKY  
**OASIS**  
RESIDENCE



Up Next



Life of Pi



Big Little Lies



Continue



TV





An unparalleled oasis nestled within the vibrant urban landscape of Jumeirah Village Circle, Dubai. Crafted by visionary architects and design experts epitomizes luxury living at its finest. Experience a lifestyle of unparalleled comfort and opulence, where every detail is meticulously curated to elevate your living experience.

**Welcome to  
Lucky Oasis Residence.**

ELEVATE YOUR  
LIFESTYLE WITH  
UNBEATABLE  
VALUE



BEACH LIKE  
RETREAT IN  
YOUR OWN  
HAVEN

BUILDING NAME





## THE ESSENCE OF ELEGANCE LIES WITHIN THE DETAILS

Refined living awaits you with our carefully curated interiors tailored to complement your well deserved lifestyle. Each detail is meticulously selected, every element thoughtfully arranged; our spaces are designed to elevate your everyday experience. From luxurious furnishings to elegant accents, immerse yourself in a sanctuary that reflects your discerning taste and enhances the quality of your life.



Lucky Oasis Residence at Jumeirah Village Circle embodies luxury living in a vibrant community. Surrounded by serene landscapes in the heart of Dubai, it offers both tranquility and energy. Positioned in a bustling area, it enjoys a great neighborhood vibe and seamless connectivity. Experience the perfect balance of serenity and excitement.

REFINED  
LIVING  
IN A DYNAMIC  
COMMUNITY



# Lucky Oasis Residence Jumeirah Village Circle Location & Accessibility



Palm Jumeirah

20 minutes



Burj Al Arab

15 minutes



Dubai International Airport

30 minutes



Burj Khalifa

20 minutes



Mall of the Emirates

20 minutes

- |                                       |  |
|---------------------------------------|--|
| 1 Jumeirah Village Circle             | 14 Dubai Media City                    |
| 2 Al Barsha South                     | 15 Palm Jumeirah                       |
| 3 Dubai Miracle Garden                | 16 Mall Of The Emirates                |
| 4 Arabian Ranches                     | 17 Dubai Hills Estate                  |
| 5 Damac Hills                         | 18 Global Village                      |
| 6 Motor City                          | 19 Burj Al Arab                        |
| 7 Dubai International Cricket Stadium | 20 World Islands                       |
| 8 Sports City                         | 21 Mohammed Bin Rashid Al Maktoum City |
| 9 Jumeirah Golf Estate                | 22 Meydan Racecourse                   |
| 10 Jumeirah Islands                   | 23 Burj Khalifa                        |
| 11 Emirates Hills                     | 24 Dubai Mall                          |
| 12 Dubai Marina                       | 25 Dubai Design District               |
| 13 Jebel Ali Race Course              | 26 Dubai International Airport         |

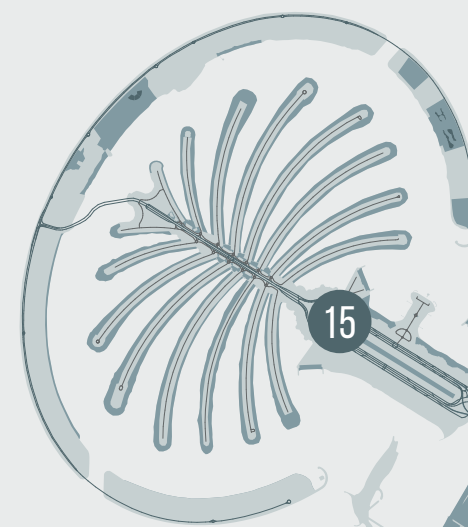



37  
Studios

84  
1 Bedroom

17  
2 Bedrooms

5  
3 Bedrooms

143  
Units Total

A modern, minimalist hallway with warm lighting and a stone counter. The hallway features a light-colored tiled floor and walls with vertical wood paneling. A long, low stone counter is positioned on the right side, topped with a black lamp and some decorative items. A large, oval-shaped mirror with a glowing gold border is mounted on the wall behind the counter. The ceiling is recessed with warm, ambient lighting. A door is visible at the end of the hallway.

AN EXQUISITE  
ENTRANCE TO  
YOUR REFINED  
OASIS



PRECISION IN  
EVERY DETAIL,  
EXCELLENCE IN  
EVERY ASPECT



Enter our kitchens, where exquisite design meets functionality. Our kitchen boasts seamless aesthetics and thoughtful details, inspiring creativity and culinary experiments. From sleek countertops to premium appliances, every element is curated to elevate your cooking experience.

WHERE EVERY  
CULINARY  
EXPERIMENT  
TRIUMPHS





SAVOUR  
THE DINING  
EXPERIENCE,  
EVERYTIME

From intimate gatherings to lavish feasts, this beautifully appointed area sets the stage for memorable moments shared with loved ones. With its tasteful decor and inviting vibe, our dining area is the perfect gathering spot in your home.



EMBRACE  
SOLACE AND  
SERENITY IN  
YOUR BEDROOM





LUXURIOUS  
SPA-INSPIRED  
BATHROOM



# A WORLD OF AMENITIES



**BEACH  
POOL**



**GOLF  
SIMULATOR**



**MINI GOLF  
COURSE**



**GAMING  
FACILITIES**



**SMART HOME  
SYSTEM**



**BALCONY  
PLUNGE POOL**



**SHALLOW  
WATER POOL**



**KIDS  
POOL**



**JOGGING  
TRACK**



**CLUB  
ROOM**

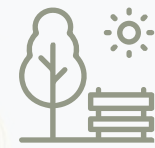

**PODIUM  
GARDEN**



**ROOFTOP  
PLUNGE POOL**



**BBQ &  
GAZEBO**



**PRAYER  
HALL**



**INDOOR FITNESS  
STUDIO**



**YOGA  
AREA**



**OUTDOOR FITNESS  
STUDIO**



**STORAGE  
SPACE**



**OUTDOOR  
CINEMA**



**HOSPITALITY  
SUITE**



**LIBRARY  
CORNER**



**INDOOR KIDS  
PLAY AREA**

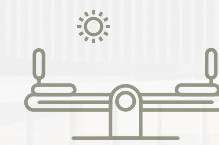

**OUTDOOR KIDS  
PLAY AREA**



**CO-WORKING  
SPACE**



**ARCADE  
ROOM**

A modern lounge area with a bar, white sofas, and a staircase. The bar has a marble top and is illuminated from below. There are three blue chairs at the bar. In the foreground, there are two white sofas on a striped rug. A coffee table with a marble top and a black base is in the center. A side table with a marble top and a black base is on the right. A white blanket is draped over the sofa on the right. A staircase with a dark railing is in the background. The walls are covered in vertical wood slats. There are several plants, including a large green plant on the bar and a smaller one on the coffee table. The lighting is warm and ambient.

CLUBHOUSE:  
ULTIMATE  
RELAXATION  
HUB

EMBRACE  
SOCIAL  
CONNECTIONS  
IN OUR  
ARCADE ROOM





Dedicated indoor gym and kids play area, ensuring fun & laughter year-round.



Co-working area, perfect for remote work or collaborative projects.



Beach-style pool, creating a resort-like experience right at home.



A DIVERSE ARRAY OF AMENITIES THAT EXCEED EXPECTATIONS



Unwind in style at the rooftop sky lounge, with panoramic views and chic ambiance.



PUT YOUR  
WAY TO  
ENDLESS  
FUN IN OUR  
MINI GOLF  
COURSE

Enjoy family-friendly fun on our mini golf course, where every swing is a delightful experience for all ages.

IMMERSE  
YOURSELF IN  
THE VIRTUAL  
GREENS,  
WHERE EVERY  
SWING FEELS  
LIKE REALITY

Perfect your swing and improve your game with our cutting-edge golf simulator, offering realistic gameplay and virtual courses from around the world.

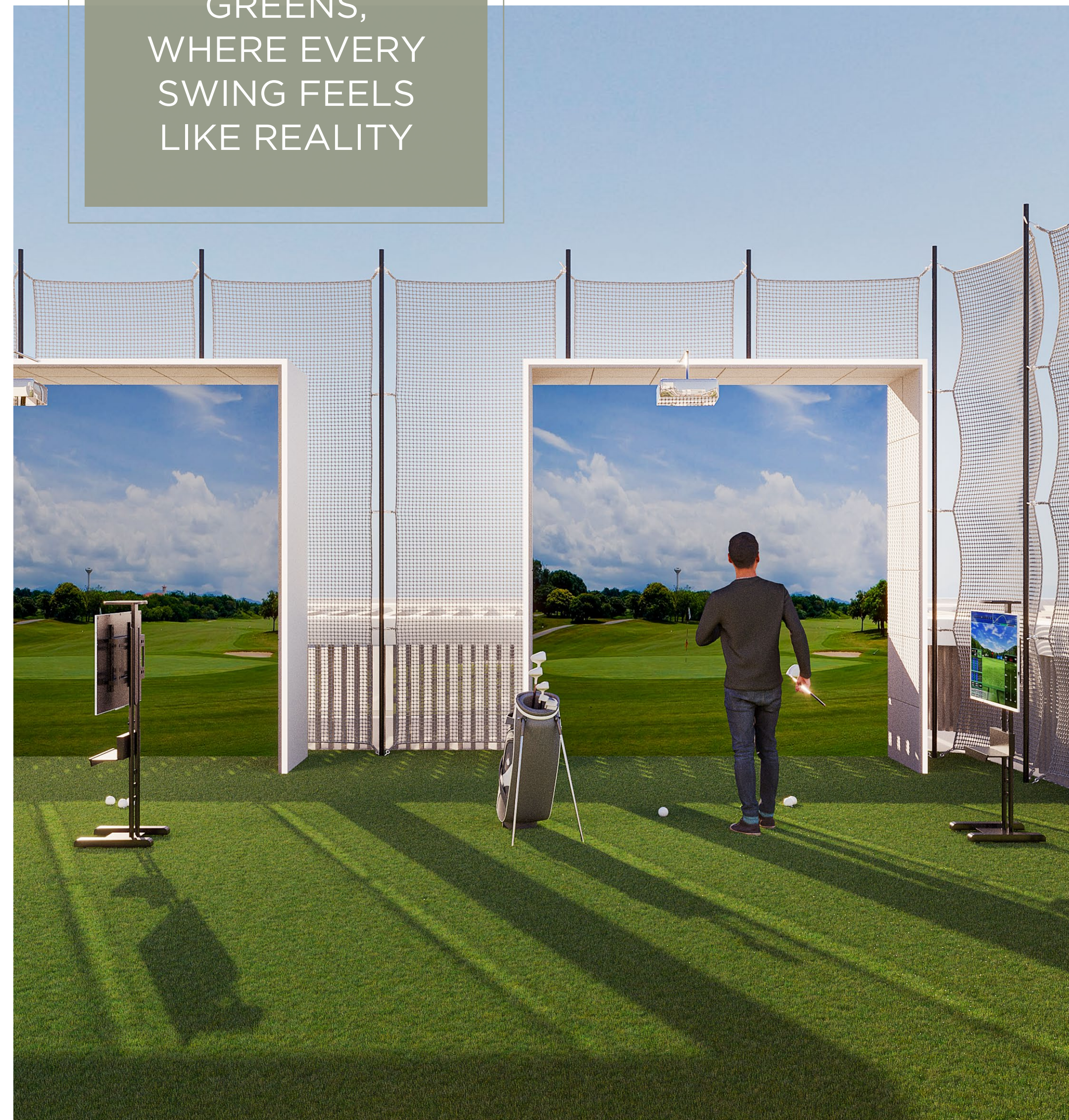

ACHIEVE  
YOUR FITNESS  
GOALS  
WITH A VIEW

Dive into your fitness journey with our fully equipped gym, featuring high-end machines and personalized training options to help you reach your goals. all with a beach pool view!



CONNECT  
YOUR BODY  
AND SOUL WITH  
A REFRESHING  
AMBIANCE

Discover inner peace and zen in our serene yoga room, designed to enhance mindfulness and relaxation through a variety of classes and meditation sessions.



# KIDS ZONE





INDOOR KIDS'  
PLAYROOM,  
A VIBRANT  
SPACE FOR  
ENDLESS FUN

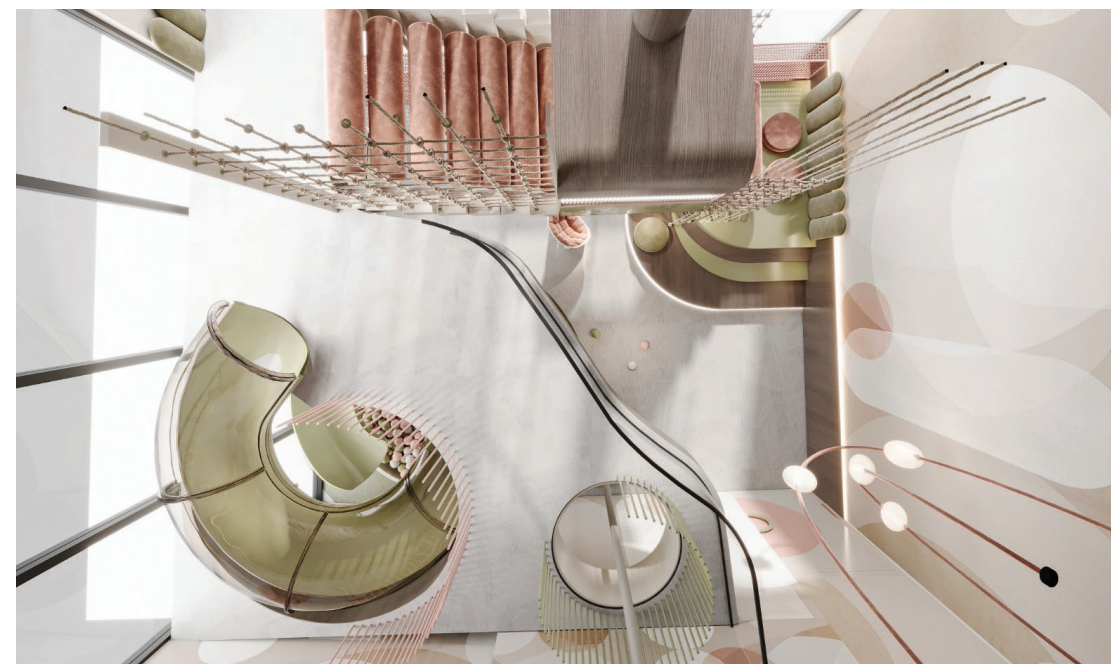

CO-WORKING  
SPACE,  
IDEAL FOR  
COLLABORATION  
AND CREATIVITY

To foster inspiration, creativity and productivity, our modern amenities and inspiring atmosphere provide the perfect backdrop for success.



DISCOVER  
SERENITY  
WITH  
PANORAMIC  
VIEWS

Indulge in luxury and comfort in our exclusive hospitality suite, designed to provide a premium retreat for guests and special occasions.

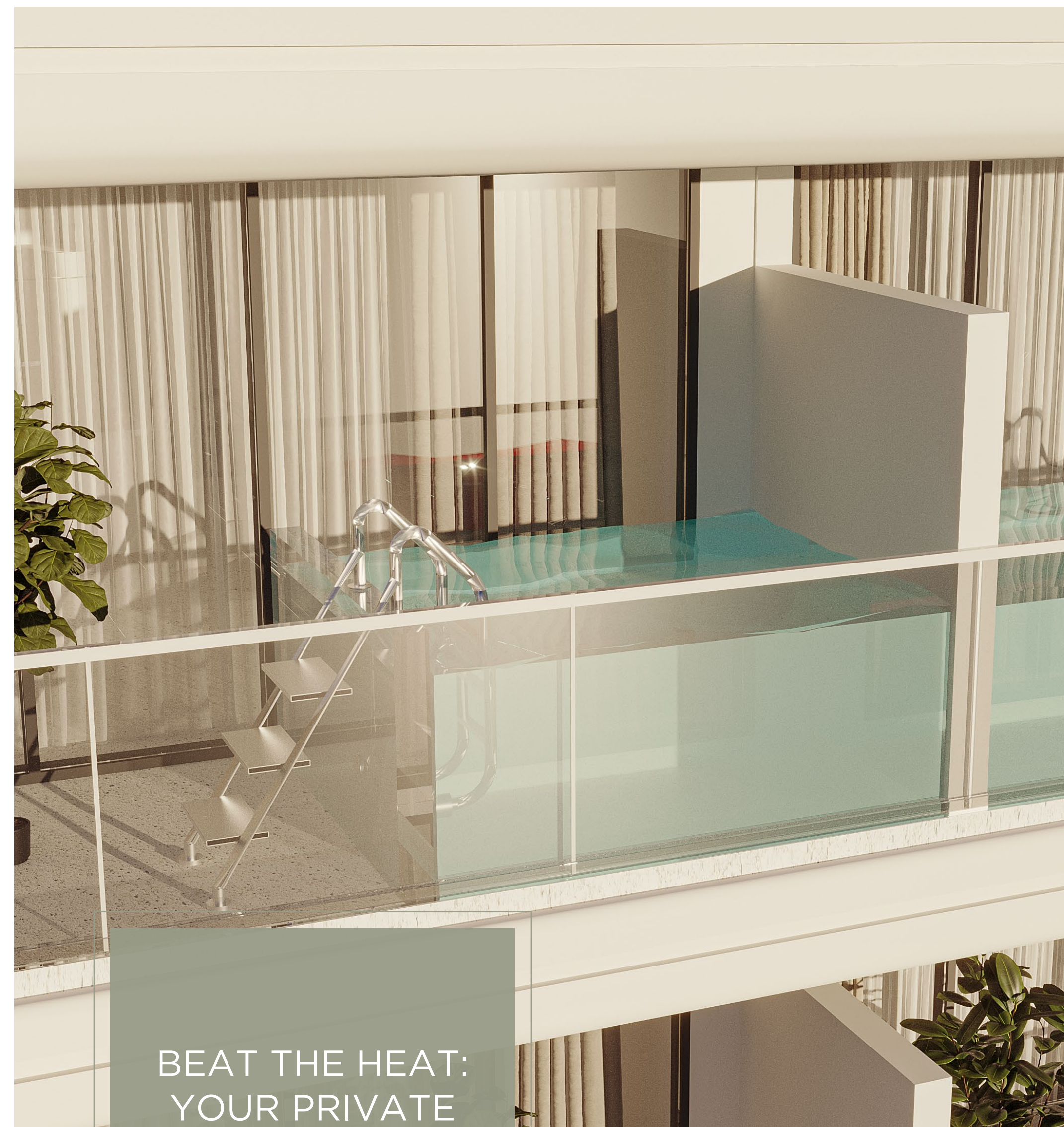

BEAT THE HEAT:  
YOUR PRIVATE  
PLUNGE  
POOL RETREAT!

Dive into luxury with your own plunge pool experience, a vacation vibe from the comfort of your home!



HOSPITALITY  
SUITE, OFFERING  
A RETREAT FOR  
YOUR VISITING  
FAMILY AND  
GUESTS

Elevate your evenings to new heights at our rooftop lounge, where you'll experience tranquil relaxation with a view.

REFLECTION &  
WORSHIP:  
YOUR EXCLUSIVE  
MOSQUE SPACE

Find peace and tranquility in our welcoming mosque prayer space, offering solace and reflection for all visitors.



CUTTING-EDGE  
SMART HOME  
SYSTEM  
UPGRADING  
MODERN LIVING

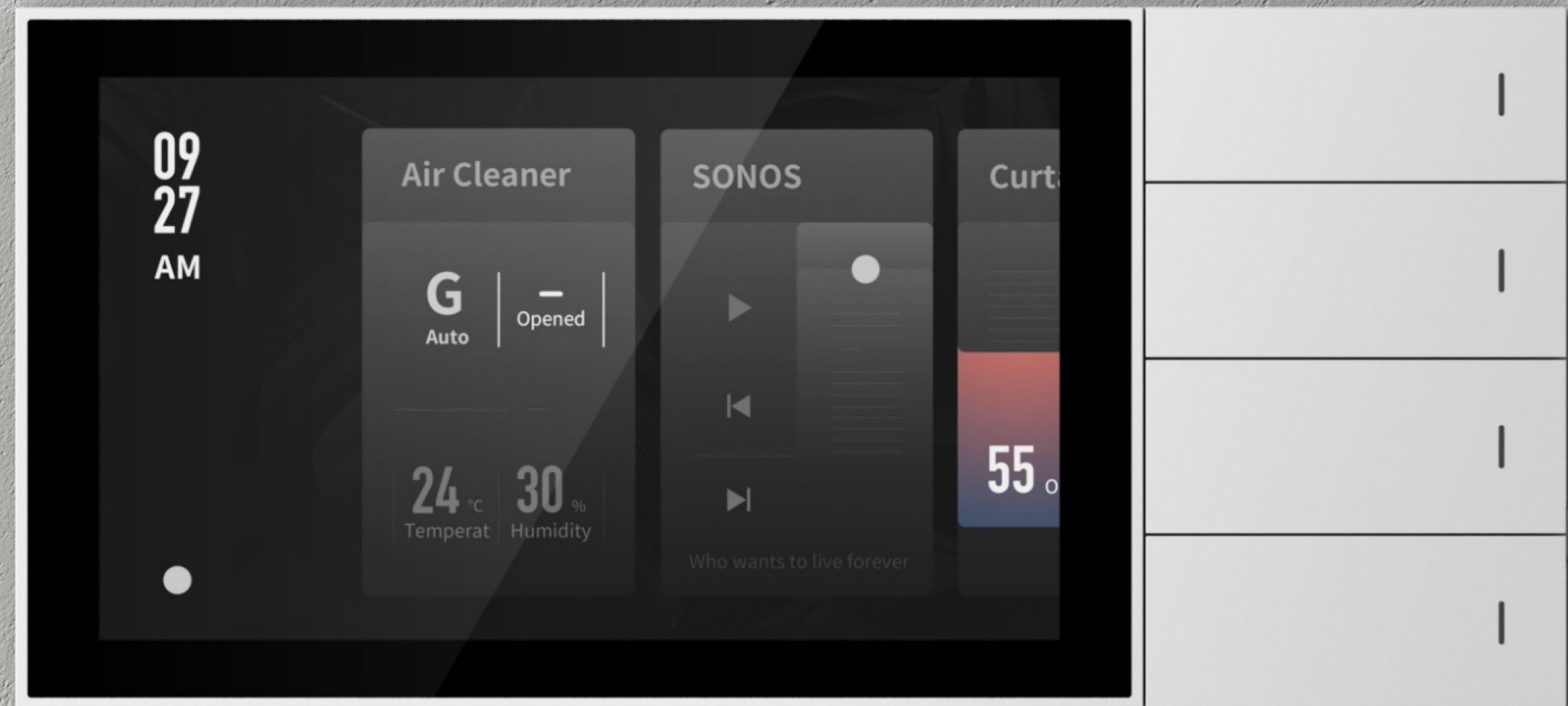



EXQUISITE  
FINISHES EXUDING  
ELEGANCE



BRANDED  
FITTINGS FOR  
ELEVATED  
LIFESTYLE



PREMIUM  
INTERIOR  
CRAFTSMANSHIP



DELIVERING  
UNPARALLELED  
QUALITY WITHOUT  
COMPROMISE



LUXURY  
LIVING  
PERFECTED

# FLOOR PLAN STUDIO



Internal Area  
351.65 sq.ft  
32.67 sq.m

Terrace Area  
76.96 sq.ft  
7.15 sq.m

Total Area  
428.61 sq.ft  
39.82 sq.m

**FLOOR PLAN  
1 BEDROOM - TYPE 1**



**Internal Area**  
750.33 sq.ft  
69.71 sq.m

**Terrace Area**  
410.21 sq.ft  
38.11 sq.m

**Total Area**  
1160.54 sq.ft  
107.82 sq.m

**FLOOR PLAN  
1 BEDROOM - TYPE 2**



**Internal Area**  
702.24 sq.ft  
65.24 sq.m

**Terrace Area**  
158.08 sq.ft  
14.50 sq.m

**Total Area**  
858.32 sq.ft  
79.74 sq.m

**FLOOR PLAN  
2 BEDROOM - TYPE 1**



**Internal Area**  
978.63 sq.ft  
90.92 sq.m

**Terrace Area**  
225.93 sq.ft  
20.99 sq.m

**Total Area**  
1204.56 sq.ft  
111.91 sq.m

**FLOOR PLAN  
2 BEDROOM - TYPE 2**



**Internal Area**  
752.81 sq.ft  
69.94 sq.m

**Terrace Area**  
408.38 sq.ft  
37.94 sq.m

**Total Area**  
1161.19 sq.ft  
107.88 sq.m

**FLOOR PLAN  
3 BEDROOM - TYPE 1**



**Internal Area**  
1464.61 sq.ft  
136.07 sq.m

**Terrace Area**  
546.35 sq.ft  
52.43 sq.m

**Total Area**  
2028.96 sq.ft  
188.50 sq.m

**FLOOR PLAN  
3 BEDROOM - TYPE 2**



**Internal Area**  
1582.82 sq.ft  
147.06 sq.m

**Terrace Area**  
978.42 sq.ft  
90.90 sq.m

**Total Area**  
2561.24 sq.ft  
237.96 sq.m



Kitchen  
**EUROPEAN KITCHEN**

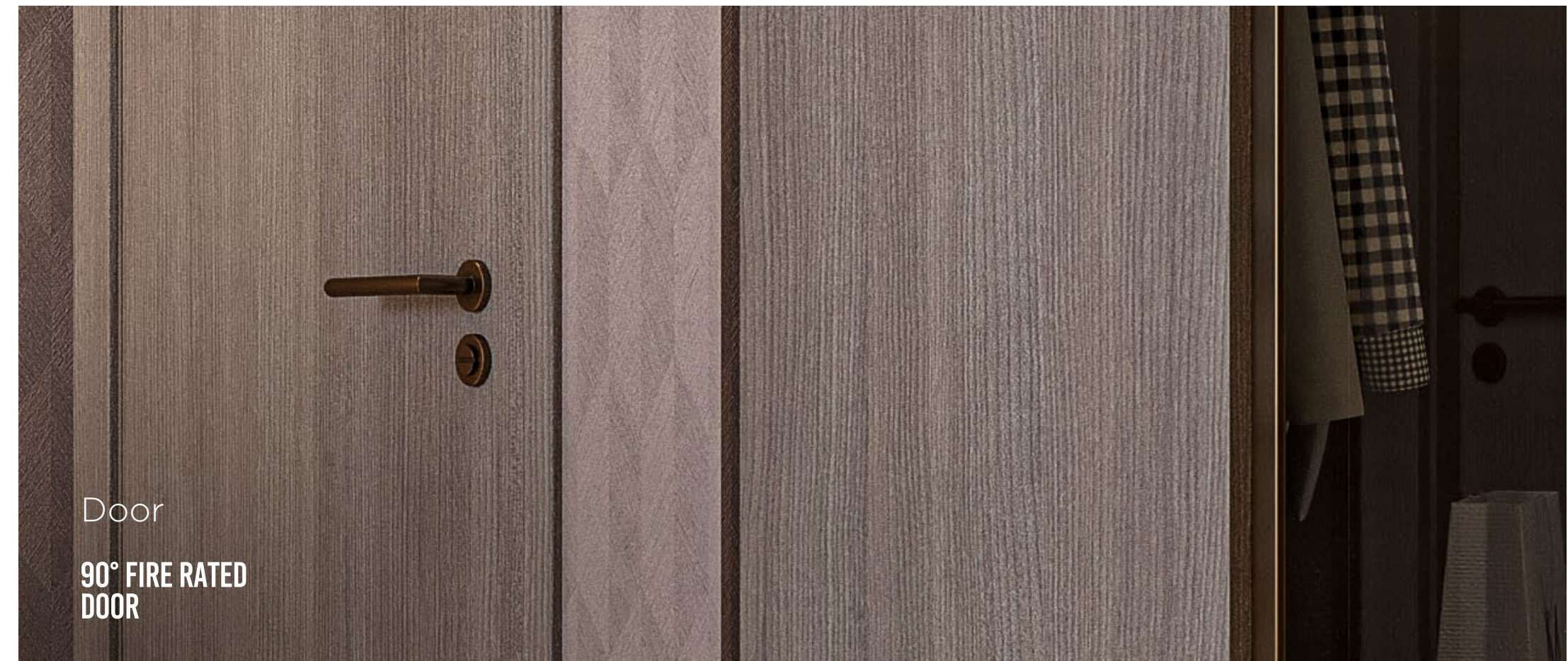

Door  
**90° FIRE RATED DOOR**

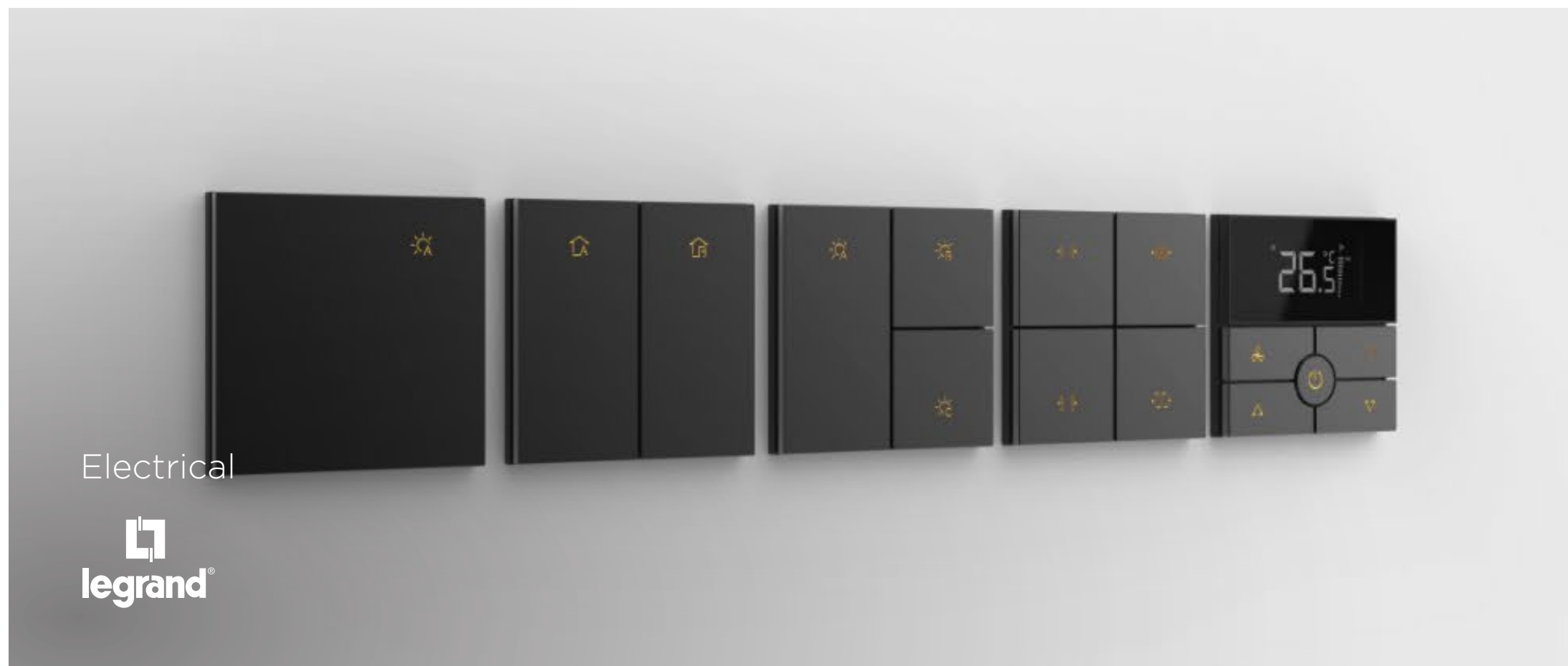

Electrical  
**legrand**

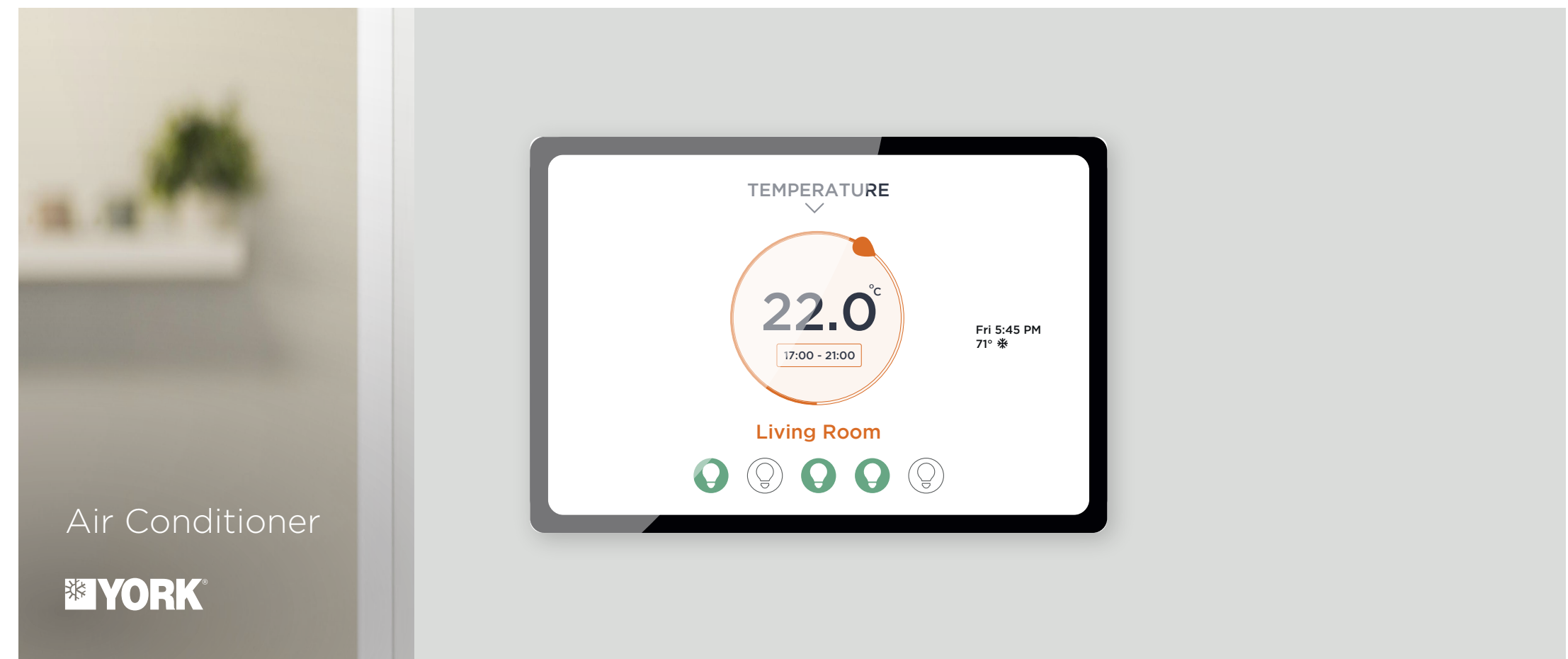

Air Conditioner  
**YORK**



Tiles  
**EUROPEAN PORCELAIN TILES**



Bathroom Fittings  
**KLUDI**



LUCKYAEON  
Real Estate Development

☎ +971 55 798 1210 | +971 4 394 0098  
info@luckyaeondevelopments.com  
www.luckyaeondevelopments.com

\*Disclaimer - Brochure content is only for illustrative purpose and subject to change.