

THREE WORLDS
ONE ADDRESS

one
RAK
central

AT

RAK CENTRAL

BY

بانتيون
PANTHEON
DEVELOPMENT

**WHERE THE SUN, SEA AND
SPACE COME TOGETHER.**



THREE WORLDS
ONE ADDRESS

one
RAK
central

AT
RAK CENTRAL

Table of Content

- | | | | |
|----|--|----|--|
| 01 | Introduction | 07 | The Third World: Design, Comfort & Style |
| 02 | The First World: Sun, Sea and Space | 08 | One RAK Central Towers Overview |
| 03 | Location Advantage | 09 | Floor Plans and Unit Plans |
| 04 | RAK Central: A New Hub in Ras Al Khaimah | 10 | Pantheon Development |
| 05 | The Second World: Passion, Pride & Privilege | | |
| 06 | Lifestyle and Community Amenities | | |

Welcome to One RAK Central

A NEW ERA OF LIVING!





Introduction

Nestled in the heart of **RAK Central**, just 6 min from the pristine **Marjan Island**, **One RAK Central** offers more than just a home - it's a seamless blend of **luxury, serenity, and convenience.**

This landmark development by Pantheon Development is designed to elevate your living experience by bringing together three worlds: the calming beauty of nature, the pride of ownership, and the elegance of modern design.

A vibrant sunset over the ocean. The sky is filled with soft, wispy clouds in shades of blue, orange, and yellow. The sun is low on the horizon, creating a bright glow and long, shimmering reflections on the water's surface. The ocean is a deep blue with gentle waves in the foreground.

**A WORLD DEFINED
BY NATURAL ELEMENTS**

The First World

Where the Sun, Sea and Space create a Life of Tranquility.

Imagine waking up to the golden glow of the sunrise, with unobstructed views of the calming sea and the vast open spaces that define One RAK Central

Here, nature is not just a backdrop -it's an essential part of your everyday life.



AT THE HEART OF RAS AL KHAIMAH'S NEWEST BUSINESS HUB!

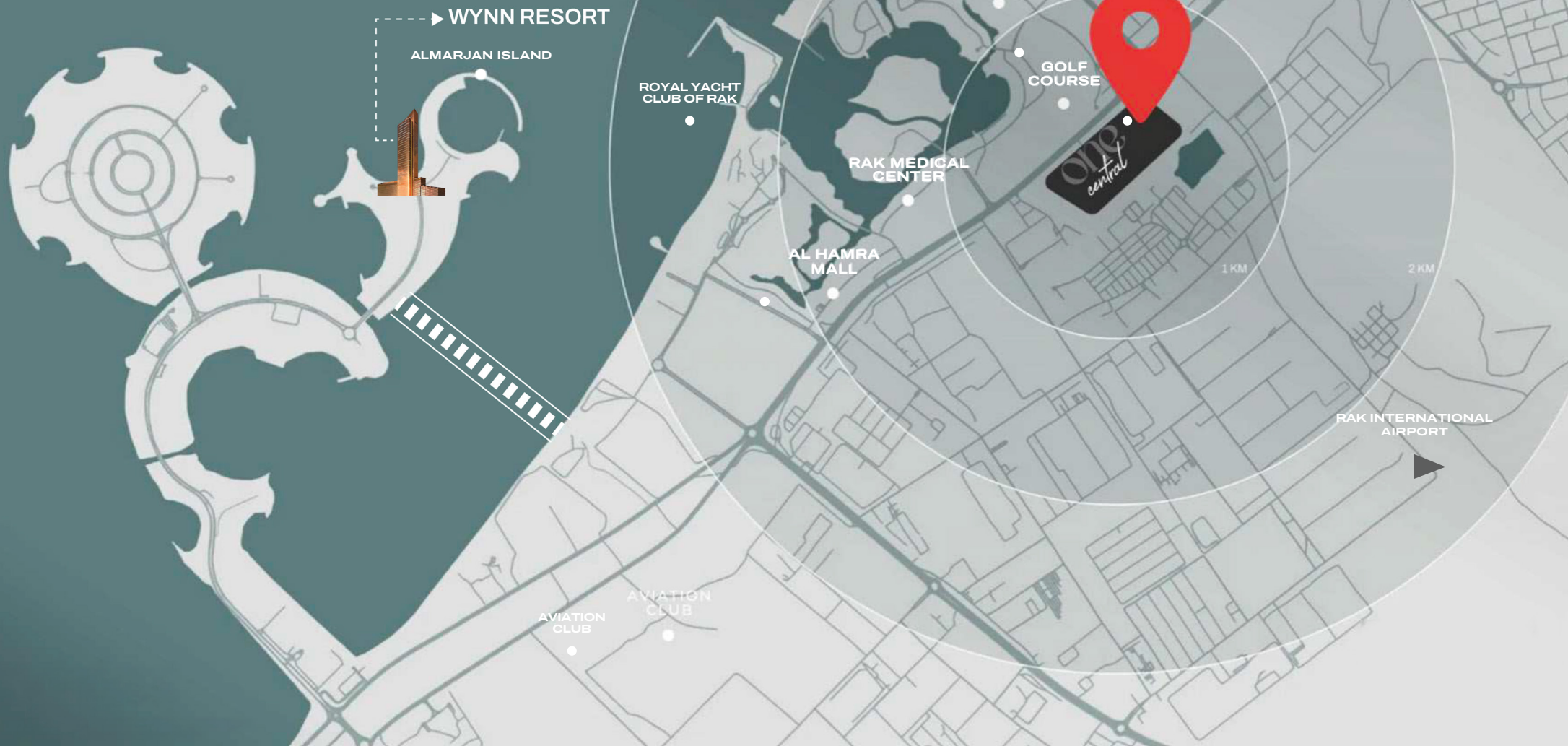



One RAK Central is located in Ras Al Khaimah's newest Business Hub, offering a prime location just 6 minutes from Marjan Island.

With close proximity to the world's largest Wynn Casino, pristine beaches, and world-class resorts, One RAK Central provides a lifestyle of unmatched luxury and convenience.

Location Highlights

Al Hamra Mall
3 Minutes

**Al Marjan Island
Beach**
6 Minutes

**Al Hamra Marina &
Yacht Club**
5 Minutes

**Ras Al Khaimah
Corniche**
15 Minutes

**Ras Al Khaimah
International Airport**
25 Minutes

**Downtown
Dubai**
1 Hour

**Dubai
International Airport**
45 Minutes



**RAK
CENTRAL**

**THE NEW HUB FOR LIVE,
WORK AND PLAY!**



Introduction

A Progressive Community Designed for a Vibrant Lifestyle.

Welcome to RAK Central, a thriving community where the boundaries of living, working, and recreation seamlessly blend into one.

This thoughtfully designed mixed-use development spans 3.1 million square feet, offering premium residences, state-of-the-art workspaces, lush green spaces, and vibrant retail and entertainment options.



A WORLD OF PRESTIGE
AND BELONGING!



one
central

THE WORLD'S ONE ADDRESS



RAK CENTRAL





The Second World

Where Passion Meets Privilege in Every Aspect of Life.

At One RAK Central, you don't just live - you belong. This is a world where luxury is more than just a word; it's a lifestyle. A lifestyle where passion, pride, and privilege are at the heart of everything we do.

From the carefully curated spaces to the attention to detail in every corner, One RAK Central reflects the aspirations of those who seek more.

A man and a woman are standing together at a night event. The woman, on the left, has long, wavy brown hair and is wearing a light-colored, sleeveless dress. She is smiling and holding a glass of champagne. The man, on the right, has short brown hair and a beard, and is wearing a dark tuxedo with a white shirt and a dark bow tie. He is also smiling and looking towards the right. The background is dark with warm, glowing string lights and a large, leafy plant on the left. The overall atmosphere is elegant and festive.

**WHERE LIFESTYLE
MEETS LEISURE**



GYM



Lobby



Theatre



Multipurpose Hall



one
cinema

Outdoor Cinema



Kids Play Area



BBQ



Sky Garden



Zen Garden



Infinity Pool

Additional Amenities

Unobstructed sea views with 25+ Amenities



Rooftop Infinity Pool



Outdoor Cinema



Zen Garden



Basket Ball



Sunken Seating Pool



Sky Yoga



Mini Golf



Sky Lounge



Padel Court



Dog Park



Jacuzzi



BBQ Area



A young man and woman are lying in bed, smiling and laughing together. The man is on the left, with his head tilted back and eyes closed, showing a wide smile. The woman is on the right, also with her eyes closed and a joyful expression. They are both wearing casual clothing. The background is a soft, warm light, suggesting a cozy bedroom environment.

A WORLD WHERE
DESIGN, COMFORT & STYLE
COME TOGETHER



Living Room



Living Room



Bedroom



Powder Room



Park View

THREE WORLDS
ONE ADDRESS

one
RAK
central

AT

RAK CENTRAL

**AN ELEVATED
LIFESTYLE IN THE HEART
OF RAK CENTRAL**



Overview

Luxury Living in Intimate, Thoughtfully Designed Towers.

One RAK Central brings luxury living and innovative workspaces to a mid-rise development thoughtfully designed to foster community and connection.

The three development - 02 residential and one commercial - are a perfect blend of contemporary design, convenience, and modern living, all within the dynamic environment of RAK Central.





THREE WORLDS
ONE ADDRESS

one
RAK
central

AT
RAK CENTRAL

A woman with long, wavy brown hair is sitting in a blue armchair outdoors. She is wearing a light-colored, long-sleeved top and brown pants. She is holding an open book in her left hand and a dark-colored mug in her right hand. She has a serene expression and is looking down at the book. The background is filled with lush green plants and foliage, with a building visible in the distance. The lighting is warm and natural, suggesting a sunny day.

**WHERE CONTEMPORARY LIVING
MEETS COMMUNITY**

RAS AL KHAIMAH THE MODERN COMMUNITY





راك سنترال
Plaza

راك سنترال
Washroom

راك سنترال
auditorium

cafe arabica LOCAL COFFEE

THOUGHTFULLY DESIGNED RESIDENCES

Modern Floor Plans Tailored for Every Lifestyle

One RAK Central offers a variety of thoughtfully designed residences to suit different lifestyles and preferences.

From cozy studios perfect for urban professionals to spacious 2-bedroom apartments ideal for families, each unit is carefully planned to maximize space, comfort, and style. With open layouts, high-quality finishes, and large windows that let in natural light, every home at One RAK Central is crafted to elevate your living experience.

WYNN

Project Floor Plan - Level 4





SEA VIEW

GOLF VIEW



PARK VIEW

UNIT LEGEND

-  STUDIO TYPE A
-  STUDIO TYPE B
-  1 BEDROOM TYPE A
-  2 BEDROOM TYPE B

WYNN

Project Floor Plan - Level 5-16

SEA VIEW

GOLF VIEW



PARK VIEW

UNIT LEGEND

- | | | | |
|------------------|------------------|------------------|------------------|
| STUDIO TYPE A | STUDIO TYPE B | 1 BEDROOM TYPE A | 2 BEDROOM TYPE A |
| 2 BEDROOM TYPE B | 2 BEDROOM TYPE C | | |

WYNN

Project Floor Plan - Level 17

SEA VIEW

GOLF VIEW

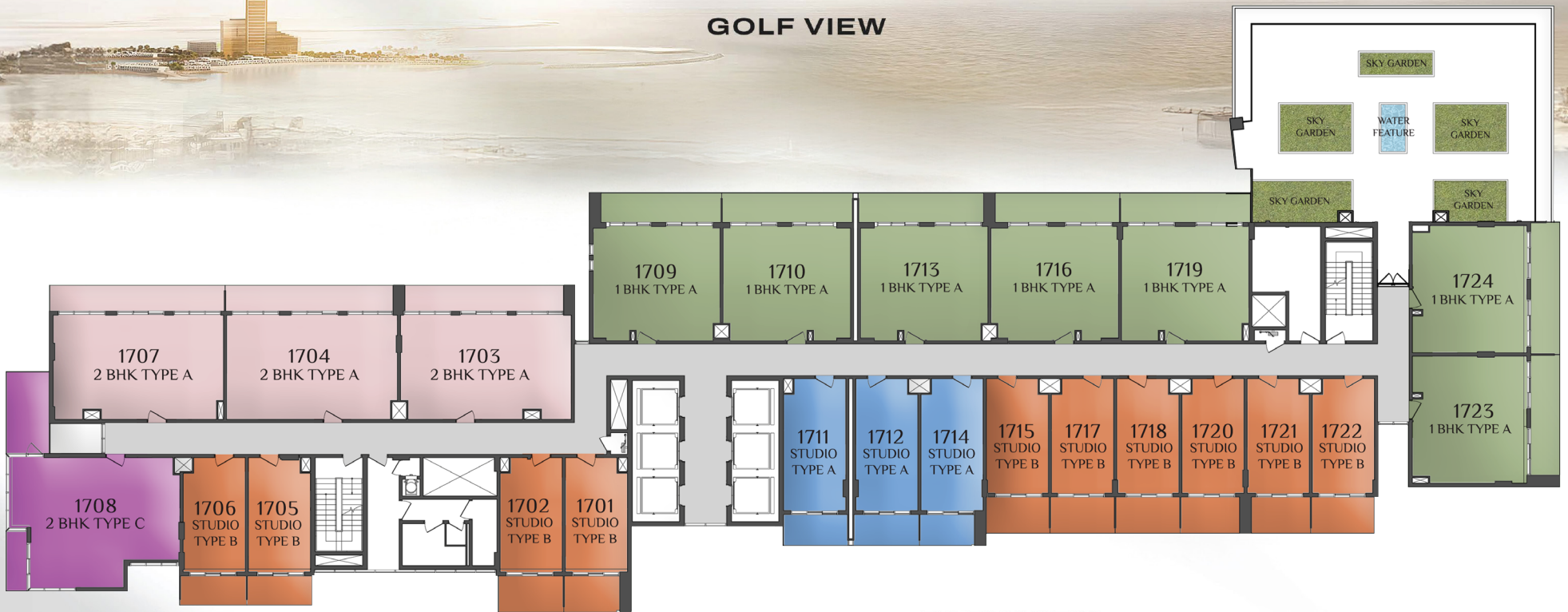

PARK VIEW

UNIT LEGEND

- STUDIO TYPE A
- STUDIO TYPE B
- 1 BEDROOM TYPE A
- 2 BEDROOM TYPE A
- 2 BEDROOM TYPE C

WYNN

Project Floor Plan - Level 18

SEA VIEW

GOLF VIEW



PARK VIEW

UNIT LEGEND

- STUDIO TYPE A
- STUDIO TYPE B
- 1 BEDROOM TYPE A
- 2 BEDROOM TYPE A
- 2 BEDROOM TYPE C

WYNN

Project Floor Plan - Level 19

SEA VIEW

GOLF VIEW

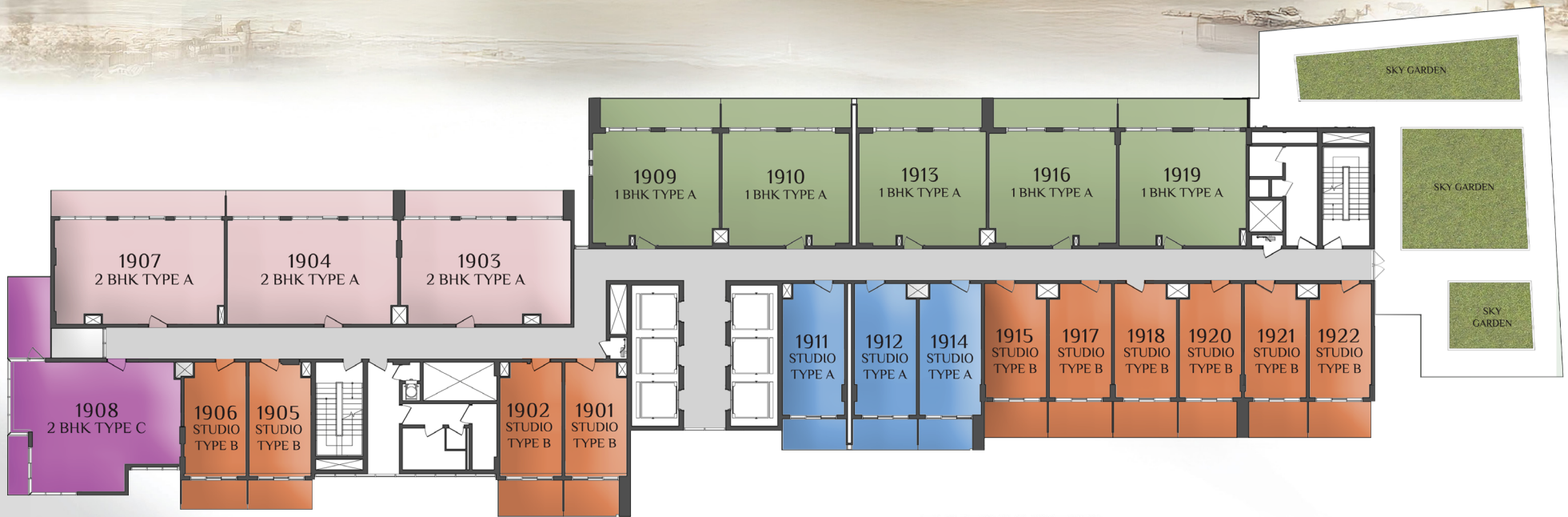

PARK VIEW

UNIT LEGEND

- STUDIO TYPE A
- STUDIO TYPE B
- 1 BEDROOM TYPE A
- 2 BEDROOM TYPE A
- 2 BEDROOM TYPE C

STUDIO
TYPICAL

| | | |
|--------------|---------------------|-----------------------|
| SUITE | 29.10 SQ. M. | 313.23 SQ. FT. |
| BALCONY | 7.20 SQ. M. | 77.50 SQ. FT. |
| TOTAL | 36.30 SQ. M. | 390.73 SQ. FT. |



01 BEDROOM-TYPE A
TYPICAL

| | | |
|--------------|---------------------|-----------------------|
| SUITE | 50.12 SQ. M. | 539.49 SQ. FT. |
| BALCONY | 13.53 SQ. M. | 145.64 SQ. FT. |
| TOTAL | 63.65 SQ. M. | 685.12 SQ. FT. |



01 BEDROOM-TYPE A
TYPICAL

| | | |
|--------------|---------------------|-----------------------|
| SUITE | 49.67 SQ. M. | 534.64 SQ. FT. |
| BALCONY | 13.30 SQ. M. | 143.16 SQ. FT. |
| TOTAL | 62.97 SQ. M. | 677.80 SQ. FT. |



02 BEDROOM-TYPE A
TYPICAL

| | | |
|--------------|---------------------|-----------------------|
| SUITE | 60.41 SQ. M. | 650.25 SQ. FT. |
| BALCONY | 15.57 SQ. M. | 167.59 SQ. FT. |
| TOTAL | 75.98 SQ. M. | 817.84 SQ. FT. |



02 BEDROOM-TYPE B
TYPICAL

| | | |
|--------------|---------------------|-----------------------|
| SUITE | 67.17 SQ. M. | 723.01 SQ. FT. |
| BALCONY | 20.65 SQ. M. | 222.27 SQ. FT. |
| TOTAL | 87.82 SQ. M. | 945.29 SQ. FT. |



02 BEDROOM-TYPE C
TYPICAL

| | | |
|--------------|---------------------|-----------------------|
| SUITE | 67.03 SQ. M. | 721.50 SQ. FT. |
| BALCONY | 16.42 SQ. M. | 176.74 SQ. FT. |
| TOTAL | 83.85 SQ. M. | 898.25 SQ. FT. |





MR. KALPESH KINARIWALA
Founder, Pantheon Group

Founder, Pantheon Development A Legacy of Excellence

Delivering Luxury & Innovation across the UAE.

Founded in 2016 by Kalpesh Kinariwala, Pantheon Development is a prominent name in luxury living, with a strong presence in Jumeirah Village Circle (JVC), Dubai. As they embark on their new venture in Ras Al Khaimah, the company brings its proven expertise, having delivered over 1,000 premium residential units and setting benchmarks in design, quality, and innovation across the UAE.

With a debt-free structure and a development portfolio exceeding 1 million sq ft of residential and commercial space, Pantheon Development is poised for growth. Their impressive project pipeline, valued at \$2 billion, reflects a commitment to creating vibrant communities that enhance lifestyles, delivering exceptional value and quality for all residents.

بـانـثـيـون
PANTHEON
DEVELOPMENT

Corporate Office

Lamborghini Building, 1st Floor,
Sheikh Zayed Rd, Umm Al Sheif,
Dubai

www.pantheondevelopment.ae