



HADLEY HEIGHTS 2

OLYMPIC CHAMPION  
EDITION

FLOOR PLANS



LEOS



**FLOOR LEVELS**

# LEVEL 01

TYPICAL PLAN

- STUDIO
- 1-BEDROOM
- 2-BEDROOM
- 3-BEDROOM

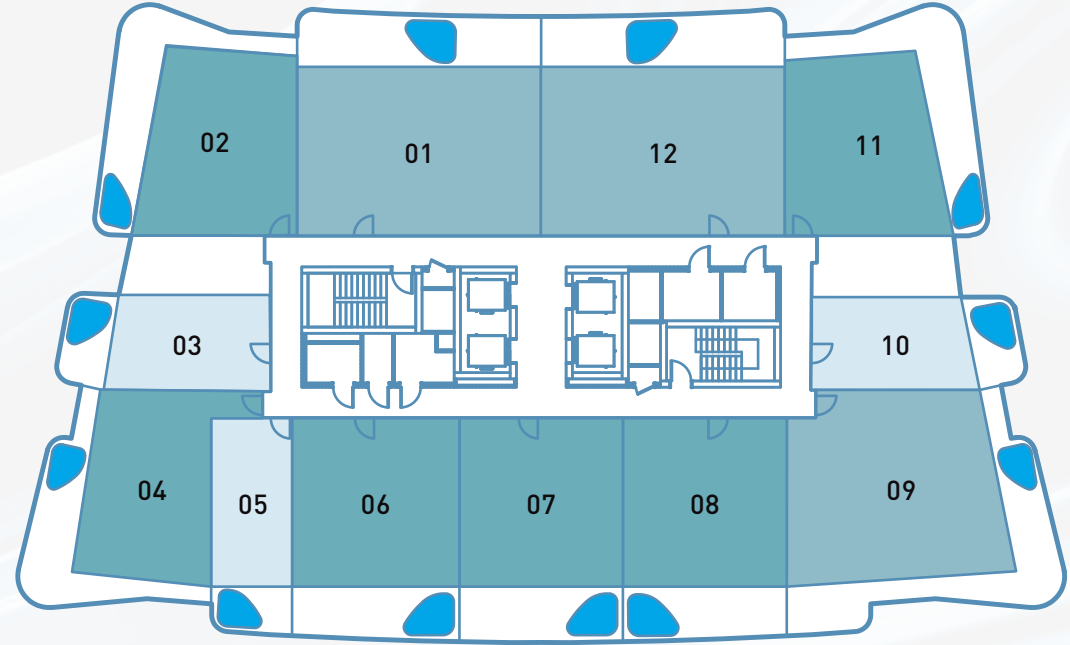

#### DISCLAIMER

All plans and 3D visualizations are based on conceptual design and are shown for illustration purposes only. Unit layouts are indicative, not to scale, and subject to change without prior notice. All dimensions, if shown, are approximate and exclude all wall finishes and construction tolerances. Furnishings & accessories shown are for representation only. The final built-up areas may vary from the official measurements issued by the 3rd party survey company accredited by the Dubai Land Department. The developer reserves the right to make any changes on any part of this document if & when they deem necessary.

# LEVELS 2-3

TYPICAL PLAN

- STUDIO
- 1-BEDROOM
- 2-BEDROOM
- 3-BEDROOM

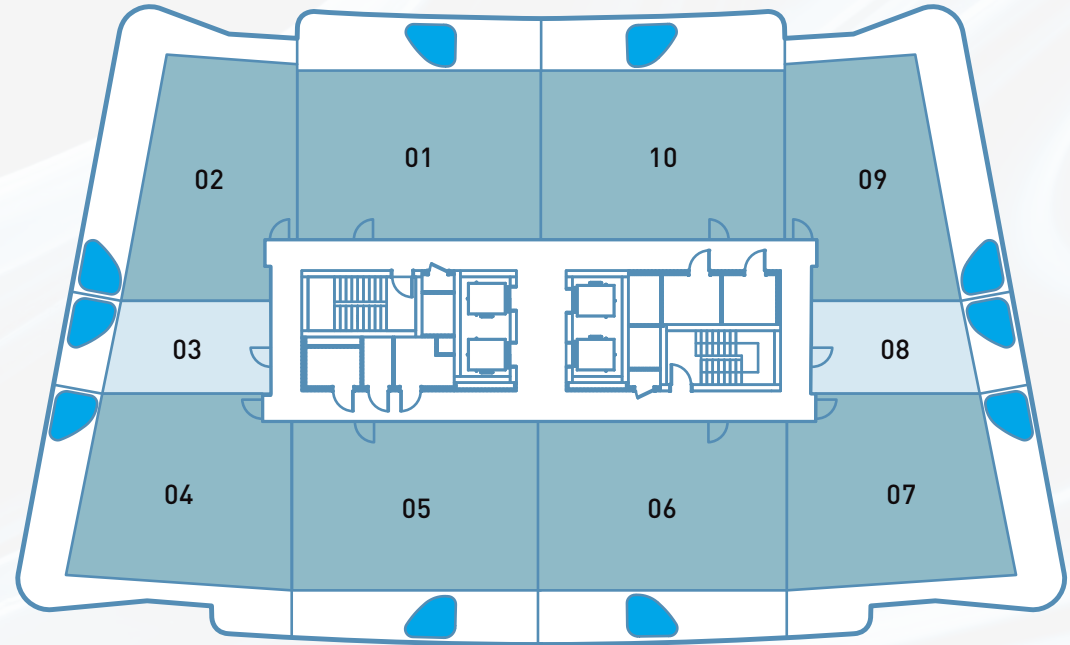

#### DISCLAIMER

All plans and 3D visualizations are based on conceptual design and are shown for illustration purposes only. Unit layouts are indicative, not to scale, and subject to change without prior notice. All dimensions, if shown, are approximate and exclude all wall finishes and construction tolerances. Furnishings & accessories shown are for representation only. The final built-up areas may vary from the official measurements issued by the 3rd party survey company accredited by the Dubai Land Department. The developer reserves the right to make any changes on any part of this document if & when they deem necessary.

# LEVELS 4-7

TYPICAL PLAN

- STUDIO
- 1-BEDROOM
- 2-BEDROOM
- 3-BEDROOM

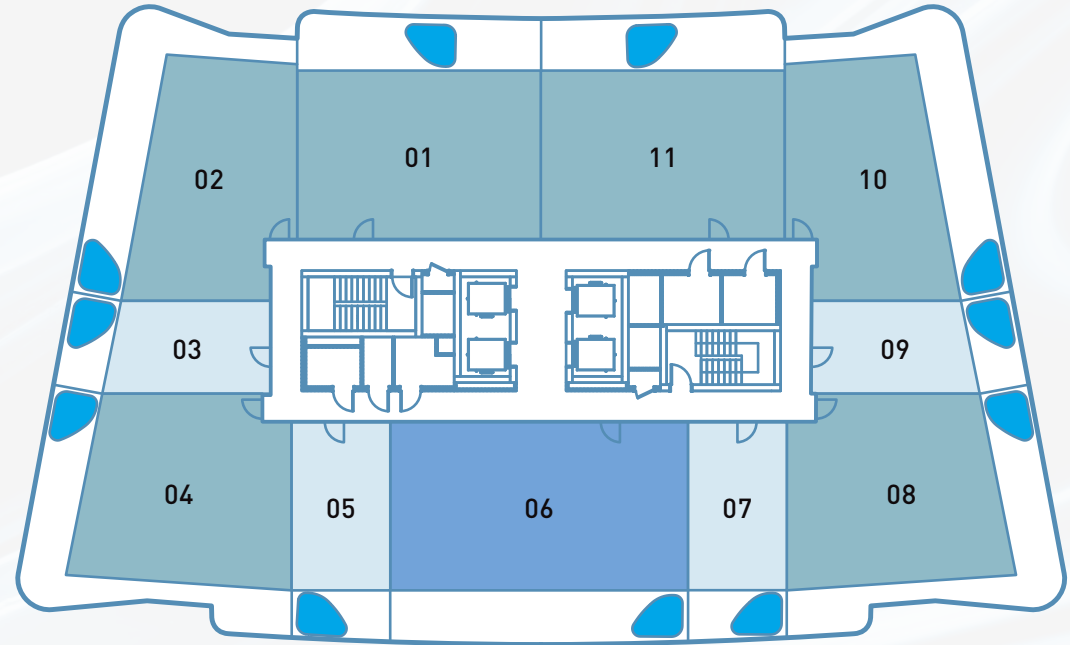

#### DISCLAIMER

All plans and 3D visualizations are based on conceptual design and are shown for illustration purposes only. Unit layouts are indicative, not to scale, and subject to change without prior notice. All dimensions, if shown, are approximate and exclude all wall finishes and construction tolerances. Furnishings & accessories shown are for representation only. The final built-up areas may vary from the official measurements issued by the 3rd party survey company accredited by the Dubai Land Department. The developer reserves the right to make any changes on any part of this document if & when they deem necessary.

# LEVELS 8-12

TYPICAL PLAN

- STUDIO
- 1-BEDROOM
- 2-BEDROOM
- 3-BEDROOM

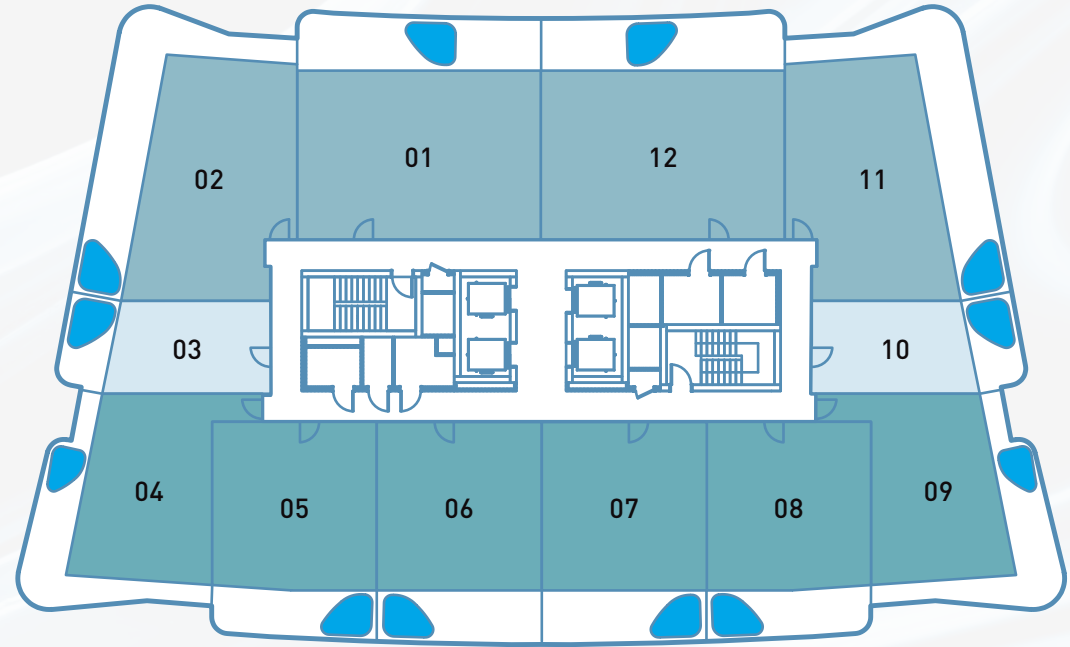

#### DISCLAIMER

All plans and 3D visualizations are based on conceptual design and are shown for illustration purposes only. Unit layouts are indicative, not to scale, and subject to change without prior notice. All dimensions, if shown, are approximate and exclude all wall finishes and construction tolerances. Furnishings & accessories shown are for representation only. The final built-up areas may vary from the official measurements issued by the 3rd party survey company accredited by the Dubai Land Department. The developer reserves the right to make any changes on any part of this document if & when they deem necessary.

# LEVELS 13-16

TYPICAL PLAN

- STUDIO
- 1-BEDROOM
- 2-BEDROOM
- 3-BEDROOM

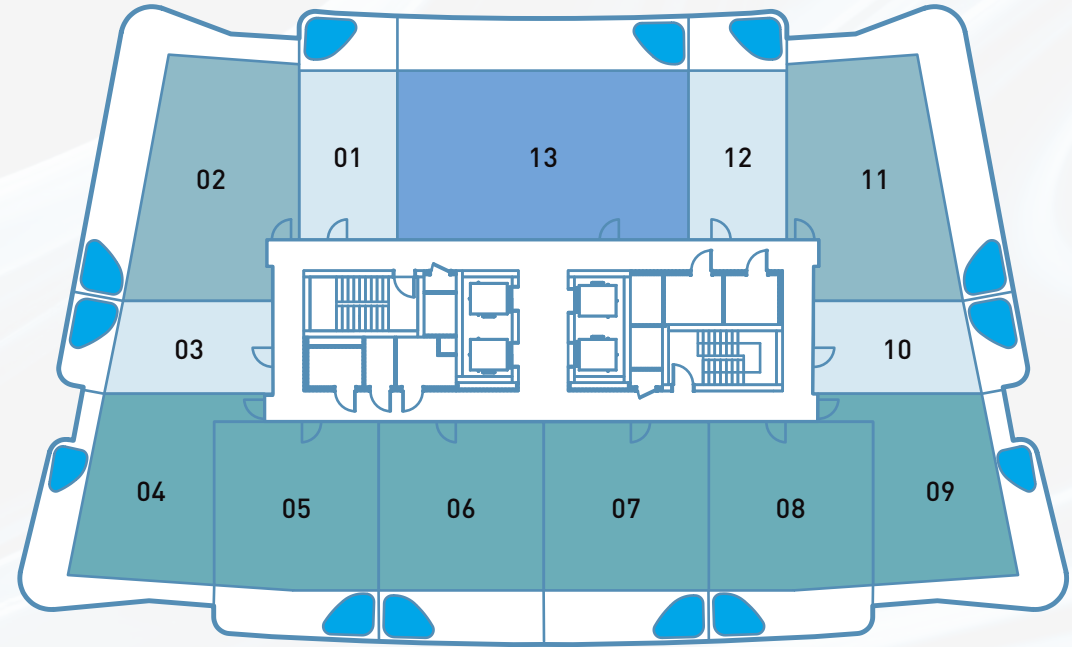

#### DISCLAIMER

All plans and 3D visualizations are based on conceptual design and are shown for illustration purposes only. Unit layouts are indicative, not to scale, and subject to change without prior notice. All dimensions, if shown, are approximate and exclude all wall finishes and construction tolerances. Furnishings & accessories shown are for representation only. The final built-up areas may vary from the official measurements issued by the 3rd party survey company accredited by the Dubai Land Department. The developer reserves the right to make any changes on any part of this document if & when they deem necessary.

# LEVELS 17-19

TYPICAL PLAN

- STUDIO
- 1-BEDROOM
- 2-BEDROOM
- 3-BEDROOM

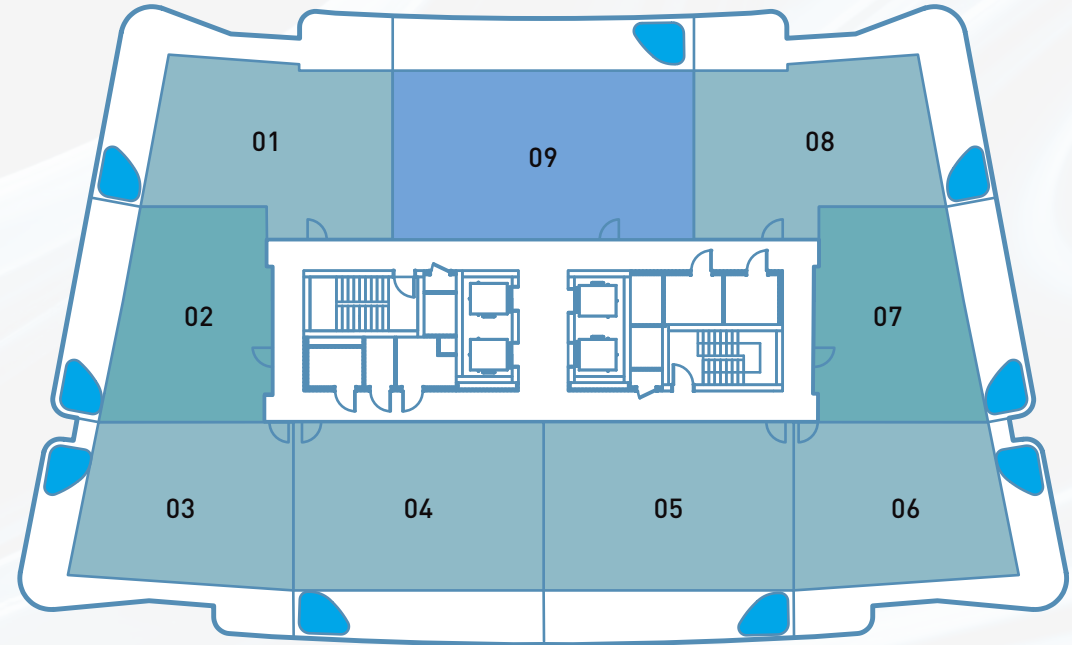

#### DISCLAIMER

All plans and 3D visualizations are based on conceptual design and are shown for illustration purposes only. Unit layouts are indicative, not to scale, and subject to change without prior notice. All dimensions, if shown, are approximate and exclude all wall finishes and construction tolerances. Furnishings & accessories shown are for representation only. The final built-up areas may vary from the official measurements issued by the 3rd party survey company accredited by the Dubai Land Department. The developer reserves the right to make any changes on any part of this document if & when they deem necessary.

# LEVEL 20

TYPICAL PLAN

- STUDIO
- 1-BEDROOM
- 2-BEDROOM
- 3-BEDROOM

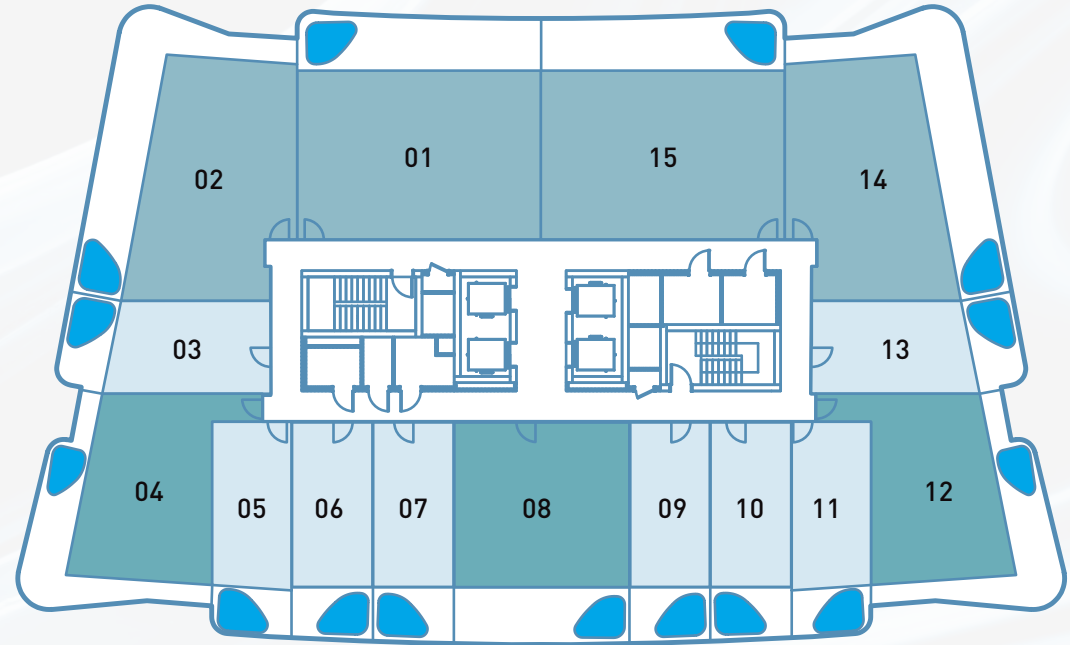

#### DISCLAIMER

All plans and 3D visualizations are based on conceptual design and are shown for illustration purposes only. Unit layouts are indicative, not to scale, and subject to change without prior notice. All dimensions, if shown, are approximate and exclude all wall finishes and construction tolerances. Furnishings & accessories shown are for representation only. The final built-up areas may vary from the official measurements issued by the 3rd party survey company accredited by the Dubai Land Department. The developer reserves the right to make any changes on any part of this document if & when they deem necessary.

# FLOOR PLANS



# STUDIO APARTMENTS

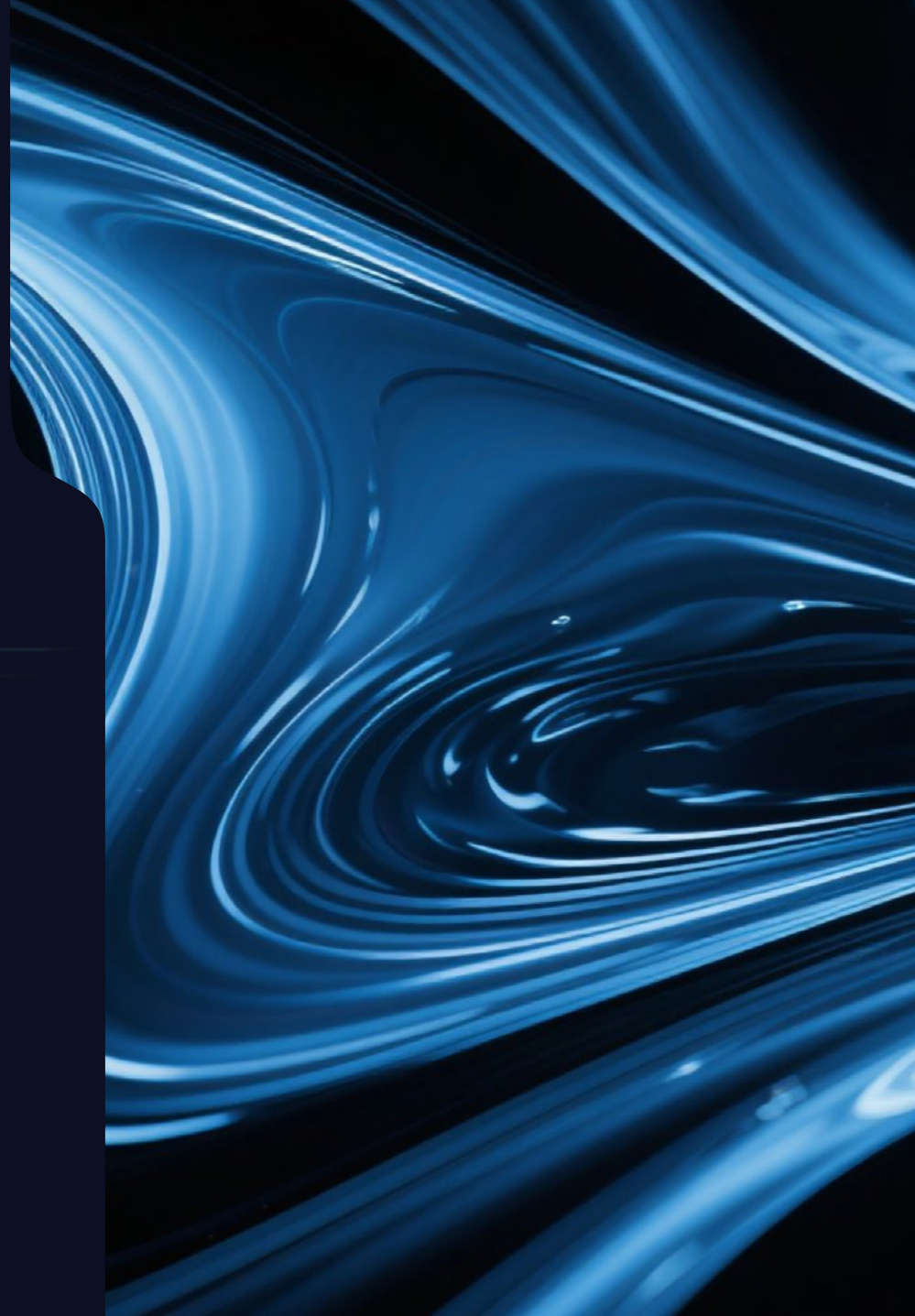

# STUDIO

UNIT 103 | TYPICAL UNIT TYPE 01A

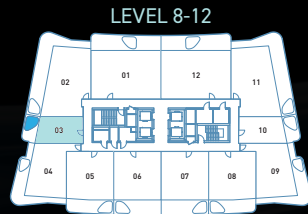
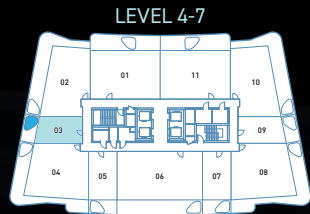
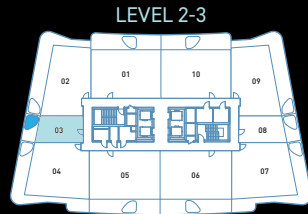
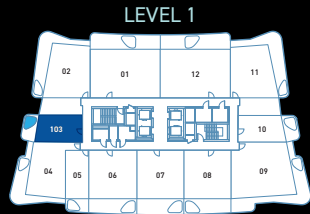

## TOTAL AREA

453.16 sq.ft.

## TOTAL INTERNAL AREA

355.64 sq.ft.

## TOTAL EXTERNAL AREA

97.52 sq.ft.



## DISCLAIMER

All plans and 3D visualizations are based on conceptual design and are shown for illustration purposes only. Unit layouts are indicative, not to scale, and subject to change without prior notice. All dimensions, if shown, are approximate and exclude all wall finishes and construction tolerances. Furnishings & accessories shown are for representation only. The final built-up areas may vary from the official measurements issued by the 3rd party survey company accredited by the Dubai Land Department. The developer reserves the right to make any changes on any part of this document if & when they deem necessary.

# STUDIO

UNIT 110 | TYPICAL UNIT TYPE 01B

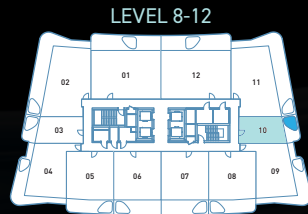
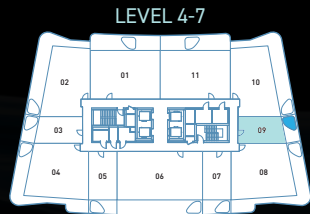

## TOTAL AREA

454.24 sq.ft.

## TOTAL INTERNAL AREA

355.75 sq.ft.

## TOTAL EXTERNAL AREA

98.49 sq.ft.



### DISCLAIMER

All plans and 3D visualizations are based on conceptual design and are shown for illustration purposes only. Unit layouts are indicative, not to scale, and subject to change without prior notice. All dimensions, if shown, are approximate and exclude all wall finishes and construction tolerances. Furnishings & accessories shown are for representation only. The final built-up areas may vary from the official measurements issued by the 3rd party survey company accredited by the Dubai Land Department. The developer reserves the right to make any changes on any part of this document if & when they deem necessary.

# STUDIO

UNIT 105 | TYPICAL UNIT TYPE 02A

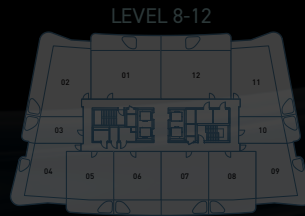
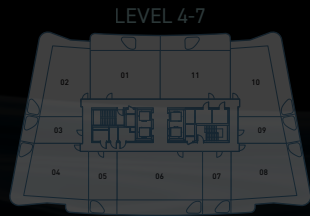

**TOTAL AREA**

422.05 sq.ft.

**TOTAL INTERNAL AREA**

329.70 sq.ft.

**TOTAL EXTERNAL AREA**

92.35 sq.ft.



## DISCLAIMER

All plans and 3D visualizations are based on conceptual design and are shown for illustration purposes only. Unit layouts are indicative, not to scale, and subject to change without prior notice. All dimensions, if shown, are approximate and exclude all wall finishes and construction tolerances. Furnishings & accessories shown are for representation only. The final built-up areas may vary from the official measurements issued by the 3rd party survey company accredited by the Dubai Land Department. The developer reserves the right to make any changes on any part of this document if & when they deem necessary.

# STUDIO

UNIT 2011 | UNIT TYPE 02B

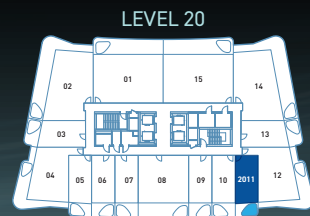
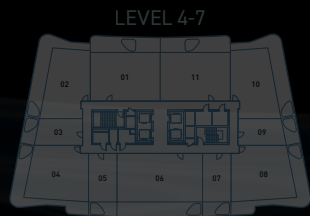

## TOTAL AREA

423.02 sq.ft.

## TOTAL INTERNAL AREA

330.45 sq.ft.

## TOTAL EXTERNAL AREA

92.57 sq.ft.



### DISCLAIMER

All plans and 3D visualizations are based on conceptual design and are shown for illustration purposes only. Unit layouts are indicative, not to scale, and subject to change without prior notice. All dimensions, if shown, are approximate and exclude all wall finishes and construction tolerances. Furnishings & accessories shown are for representation only. The final built-up areas may vary from the official measurements issued by the 3rd party survey company accredited by the Dubai Land Department. The developer reserves the right to make any changes on any part of this document if & when they deem necessary.

# STUDIO

UNIT 407 | TYPICAL UNIT TYPE 03A

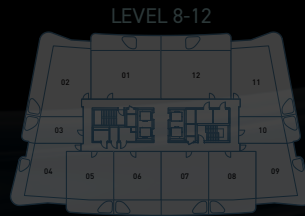
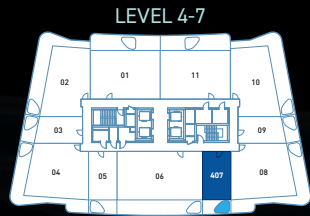

**TOTAL AREA**

510.64 sq.ft.

**TOTAL INTERNAL AREA**

383.09 sq.ft.

**TOTAL EXTERNAL AREA**

127.55 sq.ft.



#### DISCLAIMER

All plans and 3D visualizations are based on conceptual design and are shown for illustration purposes only. Unit layouts are indicative, not to scale, and subject to change without prior notice. All dimensions, if shown, are approximate and exclude all wall finishes and construction tolerances. Furnishings & accessories shown are for representation only. The final built-up areas may vary from the official measurements issued by the 3rd party survey company accredited by the Dubai Land Department. The developer reserves the right to make any changes on any part of this document if & when they deem necessary.

# STUDIO

UNIT 405 | TYPICAL UNIT TYPE 03B

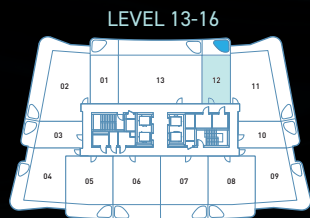
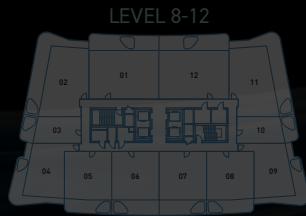

**TOTAL AREA**

511.18 sq.ft.

**TOTAL INTERNAL AREA**

383.09 sq.ft.

**TOTAL EXTERNAL AREA**

128.09 sq.ft.



#### DISCLAIMER

All plans and 3D visualizations are based on conceptual design and are shown for illustration purposes only. Unit layouts are indicative, not to scale, and subject to change without prior notice. All dimensions, if shown, are approximate and exclude all wall finishes and construction tolerances. Furnishings & accessories shown are for representation only. The final built-up areas may vary from the official measurements issued by the 3rd party survey company accredited by the Dubai Land Department. The developer reserves the right to make any changes on any part of this document if & when they deem necessary.

# 1-BEDROOM APARTMENTS

An abstract graphic on the right side of the page, featuring a dark blue background with a bright, glowing blue liquid-like shape that flows and curves downwards. The shape has a metallic sheen and is composed of many thin, overlapping layers, creating a sense of depth and movement.

# 1-BEDROOM

UNIT 102 | UNIT TYPE 01A

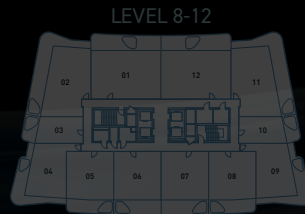
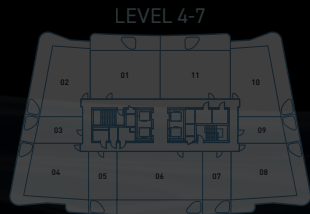
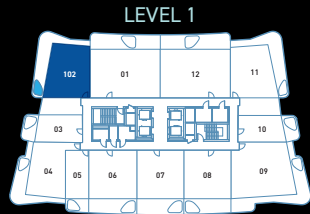

**TOTAL AREA**

947.33 sq.ft.

**TOTAL INTERNAL AREA**

655.63 sq.ft.

**TOTAL EXTERNAL AREA**

291.70 sq.ft.



#### DISCLAIMER

All plans and 3D visualizations are based on conceptual design and are shown for illustration purposes only. Unit layouts are indicative, not to scale, and subject to change without prior notice. All dimensions, if shown, are approximate and exclude all wall finishes and construction tolerances. Furnishings & accessories shown are for representation only. The final built-up areas may vary from the official measurements issued by the 3rd party survey company accredited by the Dubai Land Department. The developer reserves the right to make any changes on any part of this document if & when they deem necessary.

# 1-BEDROOM

UNIT 111 | UNIT TYPE 01B

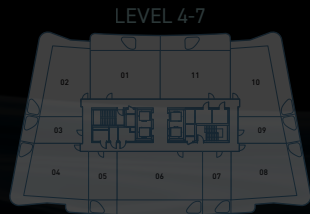
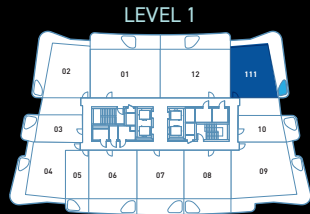

**TOTAL AREA**

948.19 sq.ft.

**TOTAL INTERNAL AREA**

656.92 sq.ft.

**TOTAL EXTERNAL AREA**

291.27 sq.ft.



#### DISCLAIMER

All plans and 3D visualizations are based on conceptual design and are shown for illustration purposes only. Unit layouts are indicative, not to scale, and subject to change without prior notice. All dimensions, if shown, are approximate and exclude all wall finishes and construction tolerances. Furnishings & accessories shown are for representation only. The final built-up areas may vary from the official measurements issued by the 3rd party survey company accredited by the Dubai Land Department. The developer reserves the right to make any changes on any part of this document if & when they deem necessary.

# 1-BEDROOM

UNIT 104 | TYPICAL UNIT TYPE 02A

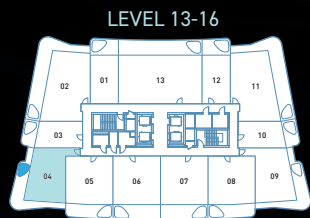
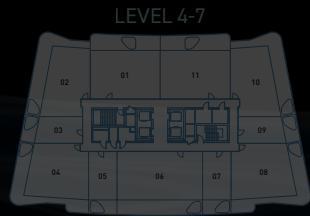

**TOTAL AREA**

911.27 sq.ft.

**TOTAL INTERNAL AREA**

630.66 sq.ft.

**TOTAL EXTERNAL AREA**

280.62 sq.ft.



**DISCLAIMER**

All plans and 3D visualizations are based on conceptual design and are shown for illustration purposes only. Unit layouts are indicative, not to scale, and subject to change without prior notice. All dimensions, if shown, are approximate and exclude all wall finishes and construction tolerances. Furnishings & accessories shown are for representation only. The final built-up areas may vary from the official measurements issued by the 3rd party survey company accredited by the Dubai Land Department. The developer reserves the right to make any changes on any part of this document if & when they deem necessary.

# 1-BEDROOM

UNIT 809 | TYPICAL UNIT TYPE 02B

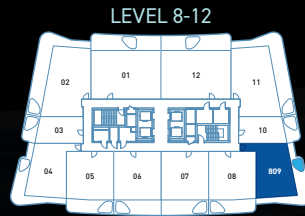
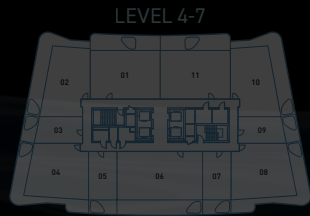

**TOTAL AREA**

910.73 sq.ft.

**TOTAL INTERNAL AREA**

629.90 sq.ft.

**TOTAL EXTERNAL AREA**

280.83 sq.ft.



#### DISCLAIMER

All plans and 3D visualizations are based on conceptual design and are shown for illustration purposes only. Unit layouts are indicative, not to scale, and subject to change without prior notice. All dimensions, if shown, are approximate and exclude all wall finishes and construction tolerances. Furnishings & accessories shown are for representation only. The final built-up areas may vary from the official measurements issued by the 3rd party survey company accredited by the Dubai Land Department. The developer reserves the right to make any changes on any part of this document if & when they deem necessary.

# 1-BEDROOM

UNIT 106 | TYPICAL UNIT TYPE 03A

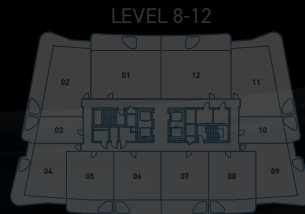
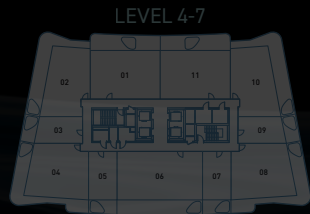

**TOTAL AREA**

880.38 sq.ft.

**TOTAL INTERNAL AREA**

656.60 sq.ft.

**TOTAL EXTERNAL AREA**

223.78 sq.ft.



**DISCLAIMER**

All plans and 3D visualizations are based on conceptual design and are shown for illustration purposes only. Unit layouts are indicative, not to scale, and subject to change without prior notice. All dimensions, if shown, are approximate and exclude all wall finishes and construction tolerances. Furnishings & accessories shown are for representation only. The final built-up areas may vary from the official measurements issued by the 3rd party survey company accredited by the Dubai Land Department. The developer reserves the right to make any changes on any part of this document if & when they deem necessary.

# 1-BEDROOM

UNIT 108 | UNIT TYPE 03B

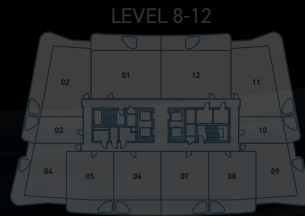
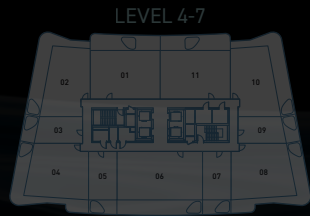

**TOTAL AREA**

879.30 sq.ft.

**TOTAL INTERNAL AREA**

655.41 sq.ft.

**TOTAL EXTERNAL AREA**

223.89 sq.ft.



#### DISCLAIMER

All plans and 3D visualizations are based on conceptual design and are shown for illustration purposes only. Unit layouts are indicative, not to scale, and subject to change without prior notice. All dimensions, if shown, are approximate and exclude all wall finishes and construction tolerances. Furnishings & accessories shown are for representation only. The final built-up areas may vary from the official measurements issued by the 3rd party survey company accredited by the Dubai Land Department. The developer reserves the right to make any changes on any part of this document if & when they deem necessary.

# 1-BEDROOM

UNIT 805 | TYPICAL UNIT TYPE 04A

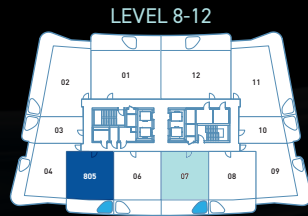
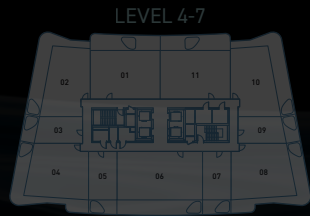

**TOTAL AREA**

858.21 sq.ft.

**TOTAL INTERNAL AREA**

657.14 sq.ft.

**TOTAL EXTERNAL AREA**

201.07 sq.ft.



**DISCLAIMER**

All plans and 3D visualizations are based on conceptual design and are shown for illustration purposes only. Unit layouts are indicative, not to scale, and subject to change without prior notice. All dimensions, if shown, are approximate and exclude all wall finishes and construction tolerances. Furnishings & accessories shown are for representation only. The final built-up areas may vary from the official measurements issued by the 3rd party survey company accredited by the Dubai Land Department. The developer reserves the right to make any changes on any part of this document if & when they deem necessary.

# 1-BEDROOM

UNIT 806 | TYPICAL UNIT TYPE 04B

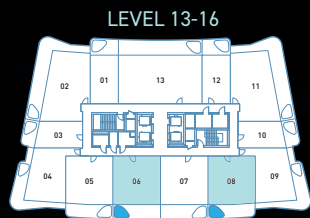
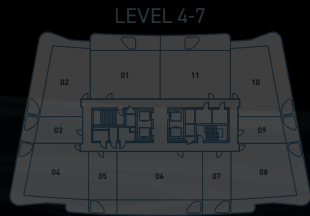

**TOTAL AREA**

888.56 sq.ft.

**TOTAL INTERNAL AREA**

655.41 sq.ft.

**TOTAL EXTERNAL AREA**

233.15 sq.ft.



**DISCLAIMER**

All plans and 3D visualizations are based on conceptual design and are shown for illustration purposes only. Unit layouts are indicative, not to scale, and subject to change without prior notice. All dimensions, if shown, are approximate and exclude all wall finishes and construction tolerances. Furnishings & accessories shown are for representation only. The final built-up areas may vary from the official measurements issued by the 3rd party survey company accredited by the Dubai Land Department. The developer reserves the right to make any changes on any part of this document if & when they deem necessary.

# 1-BEDROOM

UNIT 1702 | TYPICAL UNIT TYPE 05A

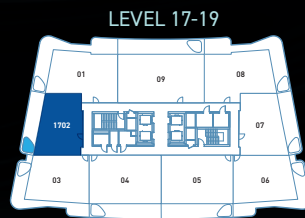
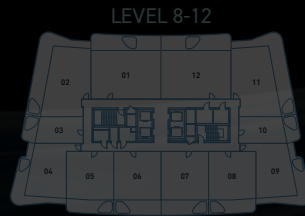
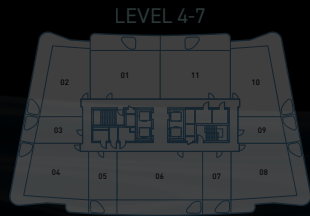

**TOTAL AREA**

1,038.61 sq.ft.

**TOTAL INTERNAL AREA**

794.38 sq.ft.

**TOTAL EXTERNAL AREA**

244.23 sq.ft.



**DISCLAIMER**

All plans and 3D visualizations are based on conceptual design and are shown for illustration purposes only. Unit layouts are indicative, not to scale, and subject to change without prior notice. All dimensions, if shown, are approximate and exclude all wall finishes and construction tolerances. Furnishings & accessories shown are for representation only. The final built-up areas may vary from the official measurements issued by the 3rd party survey company accredited by the Dubai Land Department. The developer reserves the right to make any changes on any part of this document if & when they deem necessary.

# 1-BEDROOM

UNIT 1707 | TYPICAL UNIT TYPE 05B

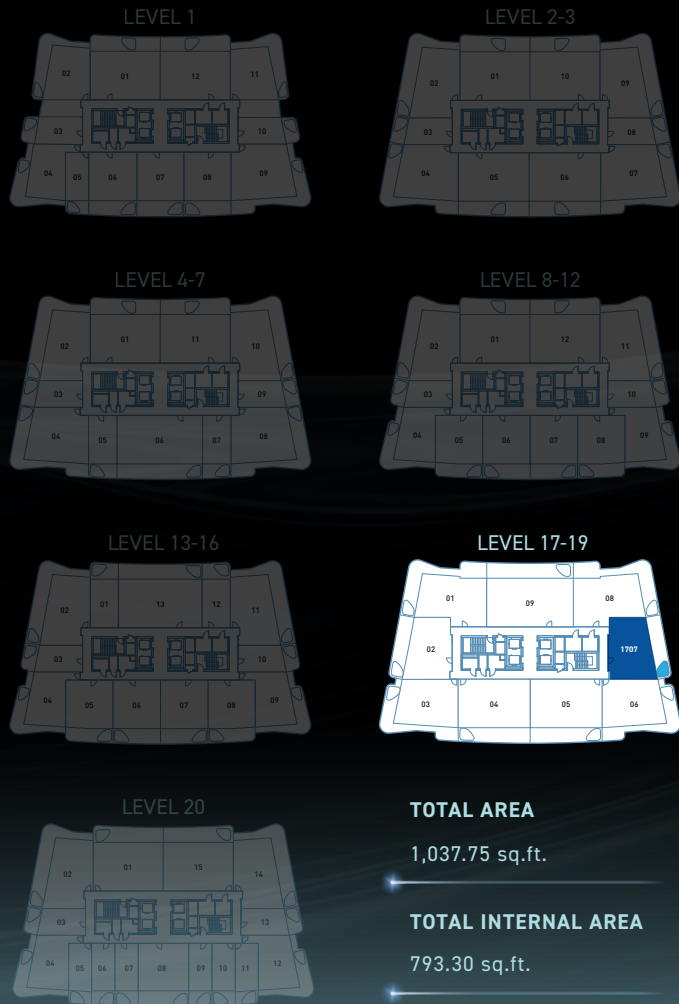

**TOTAL AREA**

1,037.75 sq.ft.

**TOTAL INTERNAL AREA**

793.30 sq.ft.

**TOTAL EXTERNAL AREA**

244.45 sq.ft.



**DISCLAIMER**

All plans and 3D visualizations are based on conceptual design and are shown for illustration purposes only. Unit layouts are indicative, not to scale, and subject to change without prior notice. All dimensions, if shown, are approximate and exclude all wall finishes and construction tolerances. Furnishings & accessories shown are for representation only. The final built-up areas may vary from the official measurements issued by the 3rd party survey company accredited by the Dubai Land Department. The developer reserves the right to make any changes on any part of this document if & when they deem necessary.

## 2-BEDROOM APARTMENTS

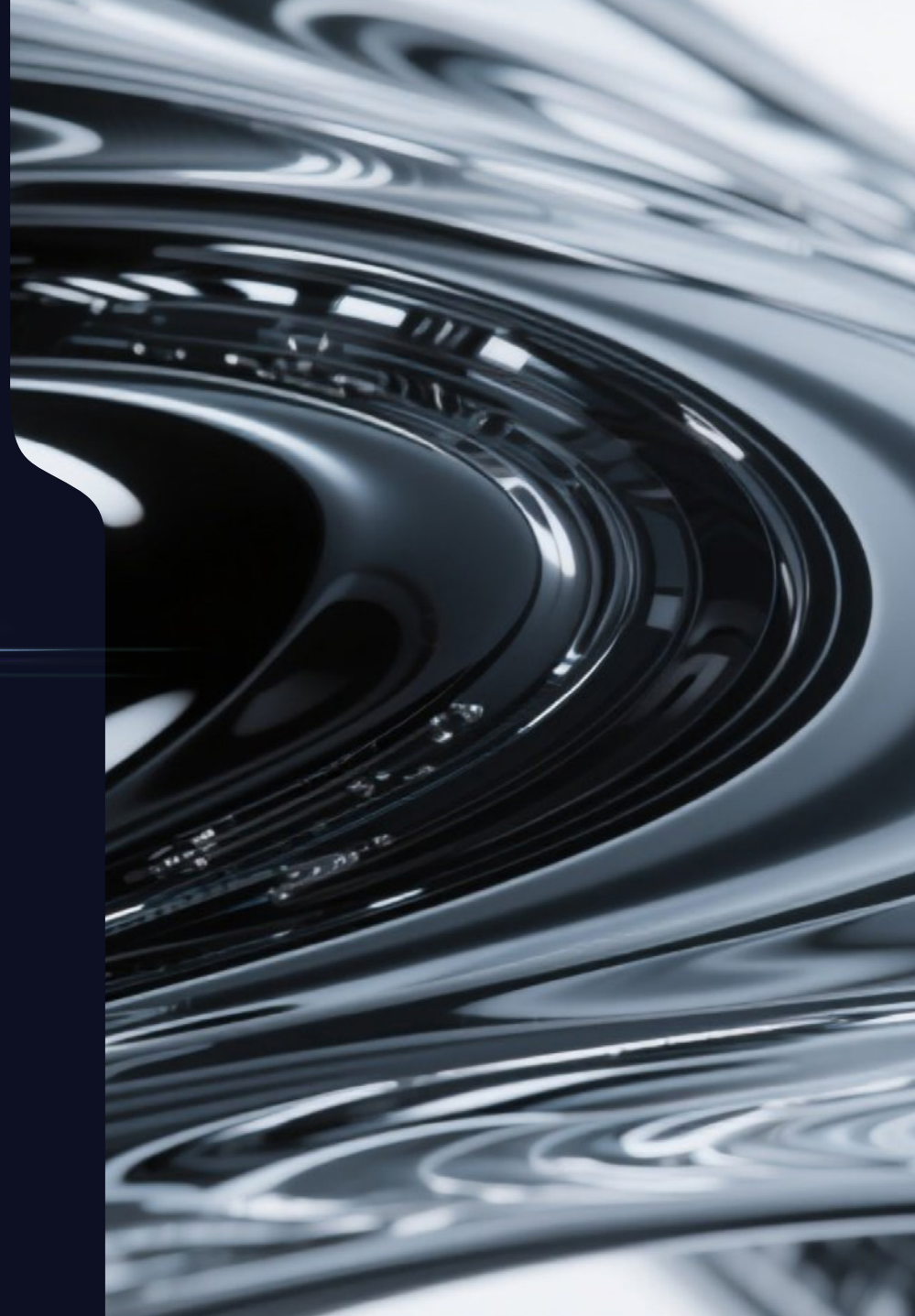

# 2-BEDROOM

UNIT 101 | TYPICAL UNIT TYPE 01A



**TOTAL AREA**

1,310.61 sq.ft.

**TOTAL INTERNAL AREA**

1,018.59 sq.ft.

**TOTAL EXTERNAL AREA**

292.02 sq.ft.



**DISCLAIMER**

All plans and 3D visualizations are based on conceptual design and are shown for illustration purposes only. Unit layouts are indicative, not to scale, and subject to change without prior notice. All dimensions, if shown, are approximate and exclude all wall finishes and construction tolerances. Furnishings & accessories shown are for representation only. The final built-up areas may vary from the official measurements issued by the 3rd party survey company accredited by the Dubai Land Department. The developer reserves the right to make any changes on any part of this document if & when they deem necessary.

# 2-BEDROOM

UNIT 2001 | TYPICAL UNIT TYPE 01AA

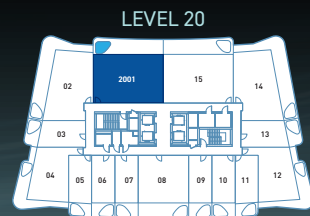
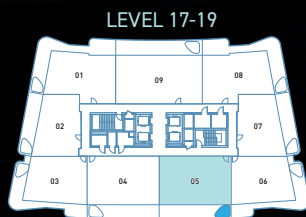
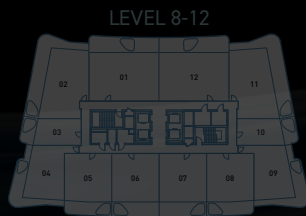
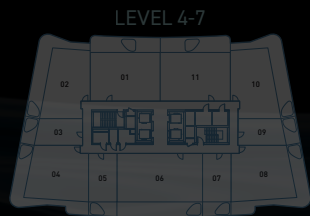

**TOTAL AREA**

1,309.54 sq.ft.

**TOTAL INTERNAL AREA**

1,017.51 sq.ft.

**TOTAL EXTERNAL AREA**

292.02 sq.ft.



#### DISCLAIMER

All plans and 3D visualizations are based on conceptual design and are shown for illustration purposes only. Unit layouts are indicative, not to scale, and subject to change without prior notice. All dimensions, if shown, are approximate and exclude all wall finishes and construction tolerances. Furnishings & accessories shown are for representation only. The final built-up areas may vary from the official measurements issued by the 3rd party survey company accredited by the Dubai Land Department. The developer reserves the right to make any changes on any part of this document if & when they deem necessary.

# 2-BEDROOM

UNIT 112 | TYPICAL UNIT TYPE 01B

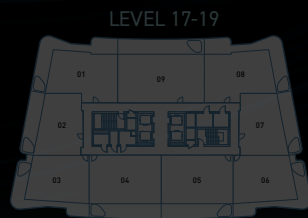
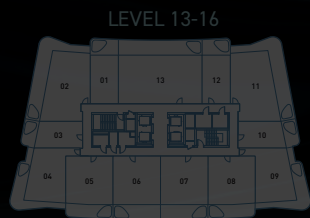
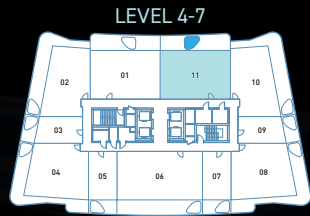

## TOTAL AREA

1,310.51 sq.ft.

## TOTAL INTERNAL AREA

1,018.70 sq.ft.

## TOTAL EXTERNAL AREA

291.81 sq.ft.



### DISCLAIMER

All plans and 3D visualizations are based on conceptual design and are shown for illustration purposes only. Unit layouts are indicative, not to scale, and subject to change without prior notice. All dimensions, if shown, are approximate and exclude all wall finishes and construction tolerances. Furnishings & accessories shown are for representation only. The final built-up areas may vary from the official measurements issued by the 3rd party survey company accredited by the Dubai Land Department. The developer reserves the right to make any changes on any part of this document if & when they deem necessary.

# 2-BEDROOM

UNIT 2015 | TYPICAL UNIT TYPE 01BB

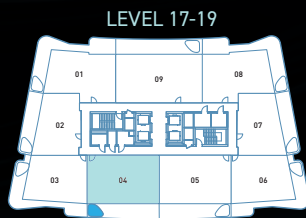
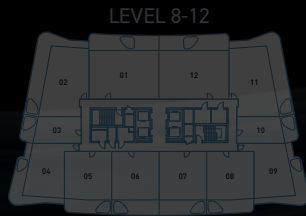
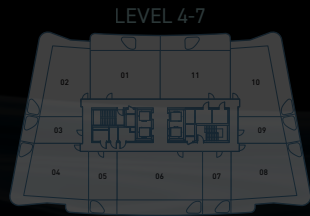

**TOTAL AREA**

1,309.32 sq.ft.

**TOTAL INTERNAL AREA**

1,017.51 sq.ft.

**TOTAL EXTERNAL AREA**

291.81 sq.ft.



**DISCLAIMER**

All plans and 3D visualizations are based on conceptual design and are shown for illustration purposes only. Unit layouts are indicative, not to scale, and subject to change without prior notice. All dimensions, if shown, are approximate and exclude all wall finishes and construction tolerances. Furnishings & accessories shown are for representation only. The final built-up areas may vary from the official measurements issued by the 3rd party survey company accredited by the Dubai Land Department. The developer reserves the right to make any changes on any part of this document if & when they deem necessary.

# 2-BEDROOM

UNIT 204 | TYPICAL UNIT TYPE 02A

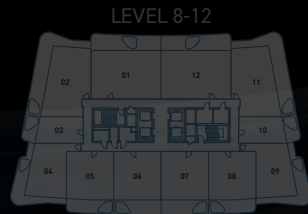
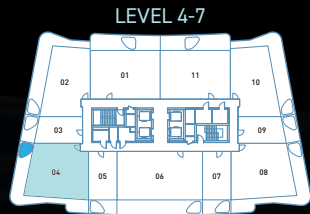

**TOTAL AREA**

1,389.73 sq.ft.

**TOTAL INTERNAL AREA**

963.15 sq.ft.

**TOTAL EXTERNAL AREA**

426.57 sq.ft.



#### DISCLAIMER

All plans and 3D visualizations are based on conceptual design and are shown for illustration purposes only. Unit layouts are indicative, not to scale, and subject to change without prior notice. All dimensions, if shown, are approximate and exclude all wall finishes and construction tolerances. Furnishings & accessories shown are for representation only. The final built-up areas may vary from the official measurements issued by the 3rd party survey company accredited by the Dubai Land Department. The developer reserves the right to make any changes on any part of this document if & when they deem necessary.

# 2-BEDROOM

UNIT 109 | TYPICAL UNIT TYPE 02B

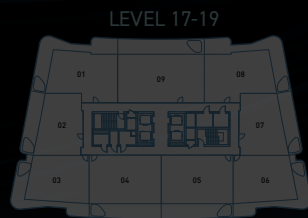
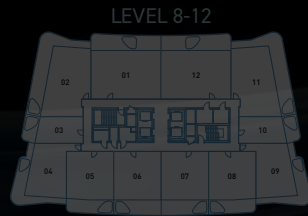
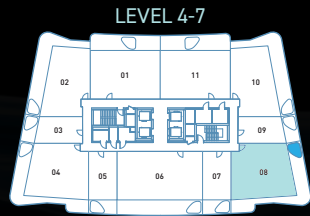

**TOTAL AREA**

1,335.80 sq.ft.

**TOTAL INTERNAL AREA**

962.83 sq.ft.

**TOTAL EXTERNAL AREA**

372.97 sq.ft.



**DISCLAIMER**

All plans and 3D visualizations are based on conceptual design and are shown for illustration purposes only. Unit layouts are indicative, not to scale, and subject to change without prior notice. All dimensions, if shown, are approximate and exclude all wall finishes and construction tolerances. Furnishings & accessories shown are for representation only. The final built-up areas may vary from the official measurements issued by the 3rd party survey company accredited by the Dubai Land Department. The developer reserves the right to make any changes on any part of this document if & when they deem necessary.

# 2-BEDROOM

UNIT 202 | TYPICAL UNIT TYPE 03A



**TOTAL AREA**

1,266.48 sq.ft.

**TOTAL INTERNAL AREA**

878.34 sq.ft.

**TOTAL EXTERNAL AREA**

388.15 sq.ft.



#### DISCLAIMER

All plans and 3D visualizations are based on conceptual design and are shown for illustration purposes only. Unit layouts are indicative, not to scale, and subject to change without prior notice. All dimensions, if shown, are approximate and exclude all wall finishes and construction tolerances. Furnishings & accessories shown are for representation only. The final built-up areas may vary from the official measurements issued by the 3rd party survey company accredited by the Dubai Land Department. The developer reserves the right to make any changes on any part of this document if & when they deem necessary.

# 2-BEDROOM

UNIT 209 | TYPICAL UNIT TYPE 03B

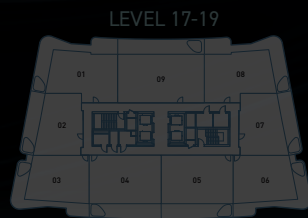
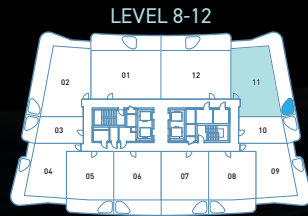
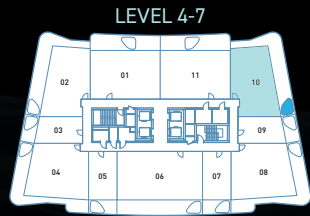

**TOTAL AREA**

1,265.73 sq.ft.

**TOTAL INTERNAL AREA**

878.98 sq.ft.

**TOTAL EXTERNAL AREA**

386.75 sq.ft.



**DISCLAIMER**

All plans and 3D visualizations are based on conceptual design and are shown for illustration purposes only. Unit layouts are indicative, not to scale, and subject to change without prior notice. All dimensions, if shown, are approximate and exclude all wall finishes and construction tolerances. Furnishings & accessories shown are for representation only. The final built-up areas may vary from the official measurements issued by the 3rd party survey company accredited by the Dubai Land Department. The developer reserves the right to make any changes on any part of this document if & when they deem necessary.

# 2-BEDROOM

UNIT 1701 | TYPICAL UNIT TYPE 04A

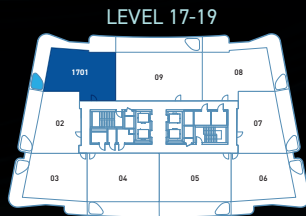
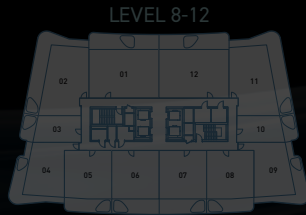

## TOTAL AREA

1,351.52 sq.ft.

## TOTAL INTERNAL AREA

949.92 sq.ft.

## TOTAL EXTERNAL AREA

401.60 sq.ft.



### DISCLAIMER

All plans and 3D visualizations are based on conceptual design and are shown for illustration purposes only. Unit layouts are indicative, not to scale, and subject to change without prior notice. All dimensions, if shown, are approximate and exclude all wall finishes and construction tolerances. Furnishings & accessories shown are for representation only. The final built-up areas may vary from the official measurements issued by the 3rd party survey company accredited by the Dubai Land Department. The developer reserves the right to make any changes on any part of this document if & when they deem necessary.

# 2-BEDROOM

UNIT 1708 | TYPICAL UNIT TYPE 04B

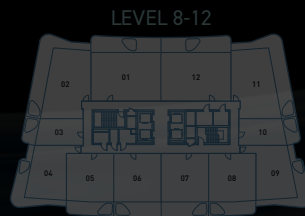
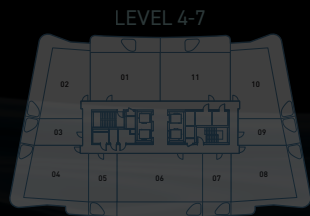

## TOTAL AREA

1,353.88 sq.ft.

## TOTAL INTERNAL AREA

953.25 sq.ft.

## TOTAL EXTERNAL AREA

400.63 sq.ft.



### DISCLAIMER

All plans and 3D visualizations are based on conceptual design and are shown for illustration purposes only. Unit layouts are indicative, not to scale, and subject to change without prior notice. All dimensions, if shown, are approximate and exclude all wall finishes and construction tolerances. Furnishings & accessories shown are for representation only. The final built-up areas may vary from the official measurements issued by the 3rd party survey company accredited by the Dubai Land Department. The developer reserves the right to make any changes on any part of this document if & when they deem necessary.

# 2-BEDROOM

UNIT 1703 | TYPICAL UNIT TYPE 05A

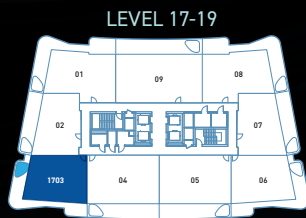
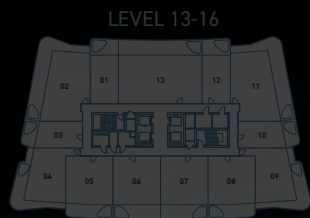
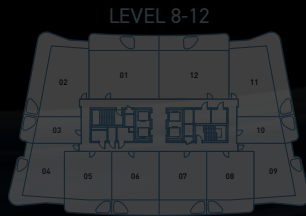
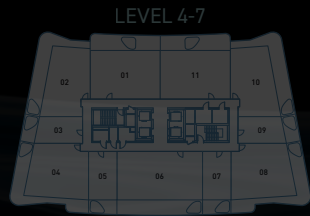

## TOTAL AREA

1,208.89 sq.ft.

## TOTAL INTERNAL AREA

837.97 sq.ft.

## TOTAL EXTERNAL AREA

370.92 sq.ft.



### DISCLAIMER

All plans and 3D visualizations are based on conceptual design and are shown for illustration purposes only. Unit layouts are indicative, not to scale, and subject to change without prior notice. All dimensions, if shown, are approximate and exclude all wall finishes and construction tolerances. Furnishings & accessories shown are for representation only. The final built-up areas may vary from the official measurements issued by the 3rd party survey company accredited by the Dubai Land Department. The developer reserves the right to make any changes on any part of this document if & when they deem necessary.

# 2-BEDROOM

UNIT 1706 | TYPICAL UNIT TYPE 05B

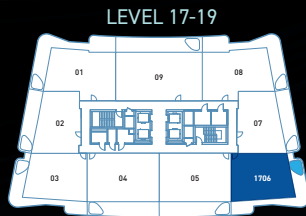
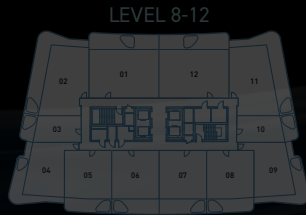

**TOTAL AREA**

1,208.25 sq.ft.

**TOTAL INTERNAL AREA**

837.76 sq.ft.

**TOTAL EXTERNAL AREA**

370.49 sq.ft.



#### DISCLAIMER

All plans and 3D visualizations are based on conceptual design and are shown for illustration purposes only. Unit layouts are indicative, not to scale, and subject to change without prior notice. All dimensions, if shown, are approximate and exclude all wall finishes and construction tolerances. Furnishings & accessories shown are for representation only. The final built-up areas may vary from the official measurements issued by the 3rd party survey company accredited by the Dubai Land Department. The developer reserves the right to make any changes on any part of this document if & when they deem necessary.

# 3-BEDROOM APARTMENTS



# 3-BEDROOM

UNIT 406 | TYPICAL UNIT TYPE 01

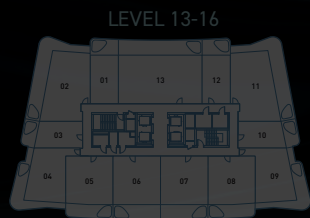
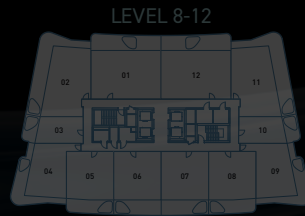
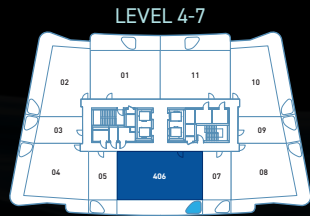

**TOTAL AREA**

1,631.70 sq.ft.

**TOTAL INTERNAL AREA**

1,203.51 sq.ft.

**TOTAL EXTERNAL AREA**

428.19 sq.ft.

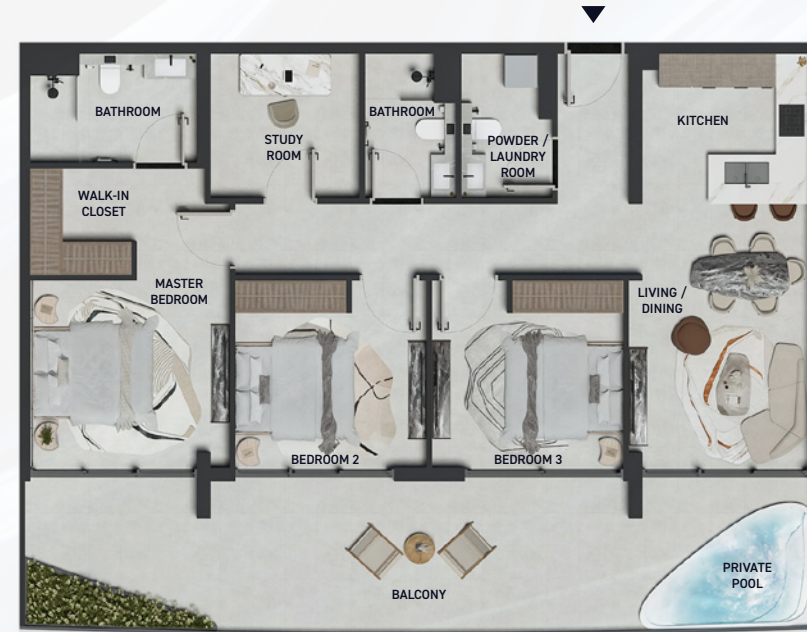

**DISCLAIMER**

All plans and 3D visualizations are based on conceptual design and are shown for illustration purposes only. Unit layouts are indicative, not to scale, and subject to change without prior notice. All dimensions, if shown, are approximate and exclude all wall finishes and construction tolerances. Furnishings & accessories shown are for representation only. The final built-up areas may vary from the official measurements issued by the 3rd party survey company accredited by the Dubai Land Department. The developer reserves the right to make any changes on any part of this document if & when they deem necessary.

# 3-BEDROOM

UNIT 1313 | TYPICAL UNIT TYPE 02

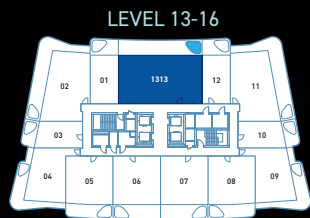
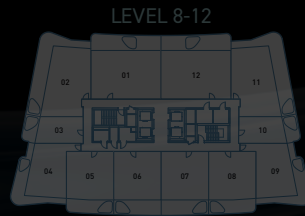
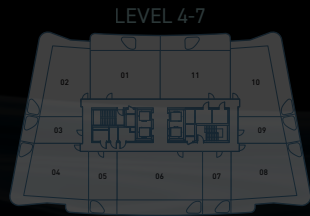

**TOTAL AREA**

1,587.03 sq.ft.

**TOTAL INTERNAL AREA**

1,242.48 sq.ft.

**TOTAL EXTERNAL AREA**

344.55 sq.ft.

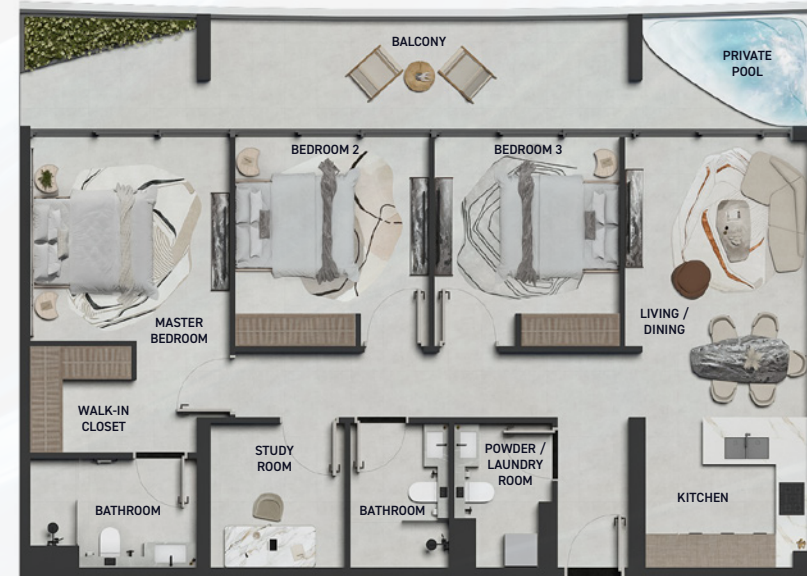

#### DISCLAIMER

All plans and 3D visualizations are based on conceptual design and are shown for illustration purposes only. Unit layouts are indicative, not to scale, and subject to change without prior notice. All dimensions, if shown, are approximate and exclude all wall finishes and construction tolerances. Furnishings & accessories shown are for representation only. The final built-up areas may vary from the official measurements issued by the 3rd party survey company accredited by the Dubai Land Department. The developer reserves the right to make any changes on any part of this document if & when they deem necessary.



LEOS

UAE TOLL-FREE 800 535  
[WWW.LEOSDEVELOPMENTS.COM](http://WWW.LEOSDEVELOPMENTS.COM)