

 fashiontv

ACACIA

BY BNW DEVELOPMENTS

AL MARJAN ISLAND



THE *finest living*
INSPIRED BY FASHION

A LIVING STATEMENT *of design and opulence*

Acacia by Fashion TV rises gracefully on the coveted shores of Al Marjan Island in Ras Al Khaimah. Designed by the globally renowned Conin International, this architectural gem harmonizes natural elements with refined artistry.

From lush landscaped courtyards to panoramic sea views, every space is designed to heighten the senses. This is a sanctuary for those who value elegance, privacy, and a front-row seat to nature's finest views.



f. Burt

A

C

A

C

I

A



FASHION *finds a* LUXURIOUS ADDRESS

Acacia presents a fashion-forward lifestyle, meticulously crafted for those with a refined eye. Blending the effortless charm of island living with modern sophistication, it redefines elegant living. Each residence is a seamless fusion of style, form, and comfort; A private runway where fashion becomes part of everyday life.



THE *blending of*
STYLE & SERENITY



A SYMPHONY OF *green & grace*

A striking entrance flanked by tree-lined boulevards sets the tone for what lies ahead, terraces that open to ocean vistas, signature interiors styled with precision, and spaces that inspire connection, calm, and celebration.





ISLAND *Living* REDEFINED BY DESIGN

At Acacia, every element has been envisioned to elevate your everyday. The architectural philosophy, crafted by Conin International, celebrates clean lines, natural light, and spatial elegance, creating a living experience that feels both intentional and effortless.

The northeast corner hosts a swimming pool, perched above a premium restaurant and connected by a stunning bridge to the main tower. Above, a state-of-the-art gym awaits, where views of the sea inspire every stretch and stride.



CENTRAL *but* UNORDINARY

To the southwest, a lush landscape unfolds, designed to soothe and mesmerise. Whether you're gazing at the gardens or soaking in the skyline, Acacia ensures that nature is never out of reach.

Acacia's address on Al Marjan Island places you at the heart of Ras Al Khaimah's most prestigious coastal enclave. Surrounded by luxury resorts, entertainment zones, and tranquil beaches, it is a destination where life moves at your pace.





the AMENITIES



Infinity Swimming Pool



Kids Pool & Play Area



State-of-the-Art Gymnasium



Café & Signature Restaurant



Viewing Deck & Water Features



Barbeque Zones & Fire Pit Corners



Lush Landscaped Gardens



Family Seating Lounges







A LIFE *that defines* INDULGENCE

Acacia is a universe of its own, where everyday life is infused with leisure, wellness, and elegant indulgence. Each amenity is designed not just to serve a purpose, but to elevate your lifestyle. Whether you're soaking in the sun, sharing a meal under the stars, or watching your little ones play, Acacia wraps every experience in warmth, elegance, and care.

the PRIME VICINITIES



06 Minutes
Al Marjan Island
Boulevard



06 Minutes
Rixos Bab-al-Bahr
Resort



07 Minutes
Wynn
Resort



11 Minutes
Al Hamra
Mall



11 Minutes
Waldorf Astoria
Hotel



11 Minutes
RAK
Central



13 Minutes
Al Hamra
Golf Club



13 Minutes
Al Hamra
Village



16 Minutes
Cosmo
Health Center



16 Minutes
Dreamland
Aqua Park



20 Minutes
Royal Yacht Club,
RAK



25 Minutes
The Ritz-Carlton,
RAK

◇ fashiontv
ACACIA
BY BNW DEVELOPMENTS



AL MARJAN
ISLAND

WYNN
RESORT



34 Minutes
RAK Airport



56 Minutes
Dubai International Airport



90 Minutes
Al Maktoum International Airport



7





LANDSCAPE AREA

A STATEMENT *in every* SQUARE FOOT

Designed by the award-winning minds at Conin International, Acacia is a modern marvel that rises gracefully over 59.2 meters with a distinctive form:

2 Basements + Ground + 12 Floors + Lower Roof + Upper Roof.

The façade plays with proportion, light, and shadow, embracing both ocean and landscaped views across its thoughtfully oriented wings. Natural ventilation, abundant daylight, and strategic planning ensure a harmonious rhythm to everyday living.





ELEGANCE *woven into* EVERY SPACE

The interiors reflect a seamless fusion of fashion, architecture, and refined living. Every element is purposefully crafted, where style doesn't just speak, it resonates.

A romantic scene at night featuring a couple standing on a stone-paved deck next to a swimming pool. The pool's water is illuminated with a soft blue light, and the sky above is filled with stars. The couple is seen from behind, embracing each other. The overall mood is serene and magical.

NIGHTS *that stay* WITH YOU

Under starlit skies and soft waves, Acacia becomes a place where time pauses and every moment is wrapped in quiet magic.







f Boutique

ACACIA

ACACIA

DESIGNED *to* BREATHE *and* BLOOM

Acacia's spatial planning is more than just architecture, it's a philosophy of flow. Each floor is designed to optimise movement, privacy, and visual connectivity with the surrounding landscapes.





THOUGHTFUL *design*, SEAMLESS *living*

With purposeful planning for natural light and ventilation, Acacia is designed to breathe. High-speed elevators ensure smooth vertical movement, while intelligently zoned layouts create fluid transitions between social and private spaces.

Terraced heights enhance visual openness, and landscaped courtyards between wings encourage quiet connections with nature. Every element reflects thoughtful architecture, crafted for refined living, delivered with intentional grace.



f | Bmw

A
C
I



1 BR - LIVING ROOM



BATHROOM



THE *fashion of* LIVING WELL

At Acacia by Fashion TV, fashion isn't just worn—it's lived. Every corner echoes the elegance of couture, with architecture and interiors curated like a runway collection. From tailored finishes to trend-forward design, this is where high style becomes your daily backdrop.







DINING AREA

VISUAL *harmony.* EVERYDAY *luxury*

From sun-drenched living rooms to moonlit terrace lounges, Acacia captures the poetry of space through refined design and immersive views. The interiors feature an aesthetic palette of clean lines and soft tones.

Whether you're hosting, unwinding, or simply in your element Acacia creates moments that feel both cinematic and deeply personal.





KIDS BEDROOM



3 BR - MASTER ROOM



PENTHOUSE LIVING ROOM



PENTHOUSE BEDROOM



TAILORED *spaces.* TIMELESS *interiors*

Every residence at Acacia is a reflection of curated comfort and modern sensibility. The unit configurations range from elegant 1-bedroom apartments to expansive 4-bedroom duplexes and triplex penthouses each thoughtfully planned to offer privacy, space, and connection to nature.



KITCHEN



KIDS PLAY AREA



TERRACE AREA



RECEPTION AREA





CRAFTED *by* ICONS, *for* ICONS

Acacia by Fashion TV is more than a residence, it's a lifestyle reserved for those who understand the power of quiet luxury. Developed by BNW Developments and envisioned by Fashion TV, every detail reflects a commitment to design, durability, and distinction.



UNIT PLANS



1BHK- TYPE A

UNIT 109

1	Kitchen	2.5mx2.5m
2	Living	3.7mx5.9m
3	PWD Room	1.3mx2m
4	Bedroom	3mx5.7m
5	Bath	1.6mx2.6m
6	Dress	1.7mx1.6m
7	Balcony	7mx2m

Suite Area	57.7 sq.m	to	62.09 sq.m
	621.08 sq.ft	to	668.33 sq.ft
Balcony Area	5.48 sq.m	to	44.56 sq.m
	58.99 sq.ft	to	479.64 sq.ft
Total Area	58.39 sq.m	to	103.89 sq.m
	628.5 sq.ft	to	1118.26 sq.ft

Level G, 1, 2, 3, 4, 5, 6, 7, 8, 9, 10, 11, 12

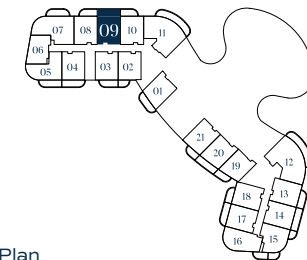

Key Plan

1BHK- TYPE B

UNIT 201



1	Kitchen	2.5mx2.7m
2	Living	3.7mx6.1m
3	PWD Room	1.3mx1.7m
4	Bedroom	3mx6.2m
5	Bath	1.6mx2.6m
6	Dress	1.7mx1.6m
7	Balcony	8.2mx2m

Suite Area	55.49 sq.m to 59.87 sq.m
	597.29 sq.ft to 644.44 sq.ft
Balcony Area	5.61 sq.m to 26.46 sq.m
	60.39 sq.ft to 284.81 sq.ft
Total Area	61.1 sq.m to 85.45 sq.m
	657.67 sq.ft to 919.78 sq.ft

Level G, 1, 2, 3, 4, 5, 6, 7, 8, 9, 10, 11, 12

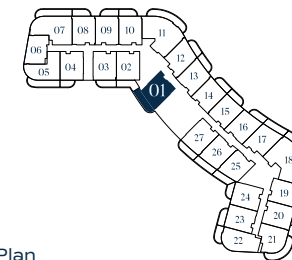

Key Plan

1BHK - TYPE C

UNIT 212



1	Kitchen	2.5mx2.7m
2	Living	3.7mx5.7m
3	PWD Room	1.2mx2.1m
4	Bedroom	3mx6.3m
5	Bath	1.7mx2.8m
6	Dress	1.7mx2m
7	Balcony	5.2mx2m

Suite Area	60.8 sq.m	to	60.81 sq.m
	654.45 sq.ft	to	654.55 sq.ft
Balcony Area	9.24 sq.m	to	14.87 sq.m
	99.46 sq.ft	to	160.06 sq.ft
Total Area	70.04 sq.m	to	75.68 sq.m
	753.9 sq.ft	to	814.61 sq.ft

Level 2, 3, 4, 5, 6, 7, 8

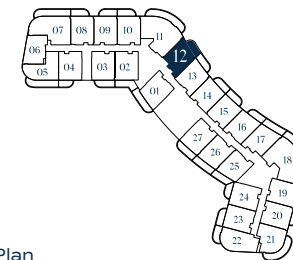

Key Plan

1BHK - TYPE D

UNIT 205



1	Kitchen	2.5m x 2.7m
2	Living	3.4m x 5.7m
3	PWD Room	1.5m x 1.4m
4	Bedroom	4m x 4.6m
5	Bath	3.2m x 1.7m
6	Dress	1.6m x 2.7m
7	Balcony	14.1m x 2m

Suite Area	63.8 sq.m
	686.74 sq.ft
Balcony Area	8.44 sq.m to 72.43 sq.m
	90.85 sq.ft to 779.63 sq.ft
Total Area	72.24 sq.m to 136.23 sq.m
	777.58 sq.ft to 1466.37 sq.ft

Level G, 1, 2, 3, 4

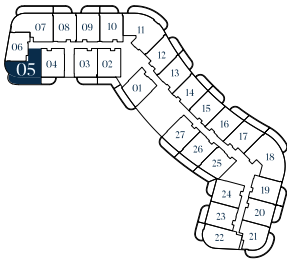

Key Plan

Disclaimer: All dimensions, materials and drawings are approximate. Information is subject to change without notice, at the developer's absolute discretion. The actual area may vary from the stated area. Drawings are not to scale. All images used are for illustrative purposes only and do not represent the actual size, features, specifications, fittings and furnishings. The developer reserves the right to make revisions/alterations, at the absolute discretion without any liability whatsoever.

1BHK - TYPE E

UNIT 221



1	Kitchen	2.5m x 2.5m
2	Living	3.8m x 5.9m
3	PWD Room	1.3m x 1.4m
4	Bedroom	4.1m x 4.4m
5	Bath	2.6m x 1.8m
6	Balcony	8.9m x 2m

Suite Area	60.01 sq.m
	645.94 sq.ft
Balcony Area	11.45 sq.m to 26.15 sq.m
	123.25 sq.ft to 281.48 sq.ft
Total Area	71.46 sq.m to 86.16 sq.m
	769.19 sq.ft to 927.42 sq.ft

Level 1, 2, 3, 4

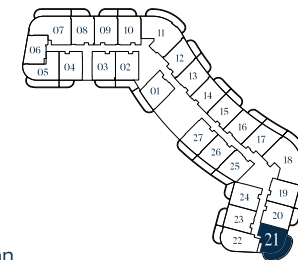

Key Plan

1BHK - TYPE F

UNIT 222



1	Kitchen	2.6m x 2.6m
2	Living	4.3m x 5.8m
3	PWD Room	1.8m x 1.5m
4	Bedroom	4.7m x 4.4m
5	Bath	2.5m x 1.7m
6	Dress	2m x 1.7m
7	Balcony	2m x 5.1m

Suite Area	66.37 sq.m	to	66.38 sq.m
	714.4 sq.ft	to	714.51 sq.ft
Balcony Area	8.61 sq.m	to	10.6 sq.m
	92.68 sq.ft	to	114.1 sq.ft
Total Area	74.98 sq.m	to	76.98 sq.m
	807.08 sq.ft	to	828.61 sq.ft

Level 1, 2, 3, 4

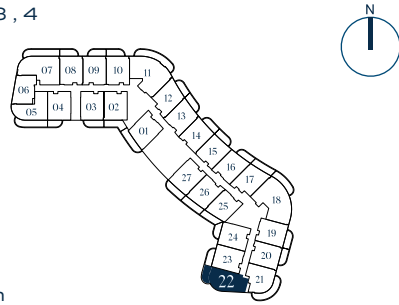

Key Plan

1BHK - TYPE G

UNIT 206



1	Kitchen	2.7mx2.5m
2	Living	5mx3.5m
3	PWD Room	1.7mx1.3m
4	Bedroom	3.4mx3.6m
5	Bath	1.6mx2.4m
6	Dress	1.7mx1.6m

Suite Area	55 sq.m
	592.02 sq.ft
Balcony Area	0.00 sq.m
	0.00 sq.ft
Total Area	55 sq.m
	592.02 sq.ft

Level 1, 2, 3, 4

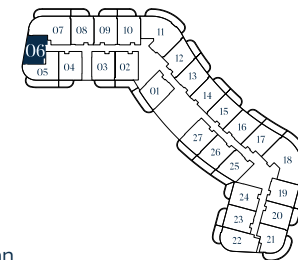

Key Plan

1BHK - TYPE H

UNIT 516



1	Kitchen	2.5m x 3m
2	Living	3.4m x 5.4m
3	PWD Room	1.7m x 1.5m
4	Bedroom	7.1m x 3.8m
5	Bath	1.6m x 3m
6	Balcony	5.4m x 2m

Suite Area	68.05 sq.m
	732.48 sq.ft
Balcony Area	10.58 sq.m to 20.31 sq.m
	113.88 sq.ft to 218.62 sq.ft
Total Area	78.63 sq.m to 88.36 sq.m
	846.37 sq.ft to 951.1 sq.ft

Level 5, 6

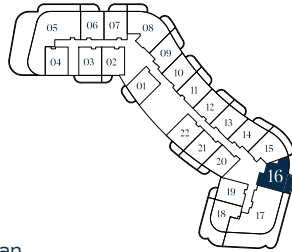

Key Plan

Disclaimer: All dimensions, materials and drawings are approximate. Information is subject to change without notice, at the developer's absolute discretion. The actual area may vary from the stated area. Drawings are not to scale. All images used are for illustrative purposes only and do not represent the actual size, features, specifications, fittings and furnishings. The developer reserves the right to make revisions/alterations, at the absolute discretion without any liability whatsoever.

1BHK - TYPE I

UNIT 518



1	Kitchen	2.4mx2.7m
2	Living	3.5mx5.6m
3	PWD Room	1.6mx1.3m
4	Bedroom	3.3mx5.4m
5	Bath	1.6mx2.6m
6	Dress	1.6mx1.6m
7	Balcony -1	11.9mx2m
8	Balcony -2	4.3mx7.8m

Suite Area	57.66 sq.m	to	58.54 sq.m
	620.65 sq.ft	to	630.12 sq.ft
Balcony Area	6.44 sq.m	to	50.48 sq.m
	69.32 sq.ft	to	543.36 sq.ft
Total Area	64.4 sq.m	to	109.02 sq.m
	693.2 sq.ft	to	1173.48 sq.ft

Level 5 , 6 , 7 , 8



Key Plan

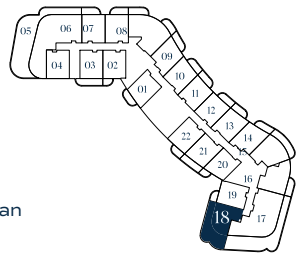

Disclaimer: All dimensions, materials and drawings are approximate. Information is subject to change without notice, at the developer's absolute discretion. The actual area may vary from the stated area. Drawings are not to scale. All images used are for illustrative purposes only and do not represent the actual size, features, specifications, fittings and furnishings. The developer reserves the right to make revisions/alterations, at the absolute discretion without any liability whatsoever.

1BHK - TYPE J

UNIT 515



1	Kitchen	2.5m x 2.7m
2	Living	3.7m x 6.1m
3	PWD Room	2m x 1.4m
4	Bedroom	5.6m x 6.3m
5	Bath	2.7m x 1.7m
6	Balcony	9.8m x 2.1m

Suite Area	68.76 sq.m
	740.13 sq.ft
Balcony Area	17.01 sq.m to 20.41 sq.m
	183.09 sq.ft to 219.69 sq.ft
Total Area	85.77 sq.m to 89.17 sq.m
	923.22 sq.ft to 959.82 sq.ft

Level 5, 6

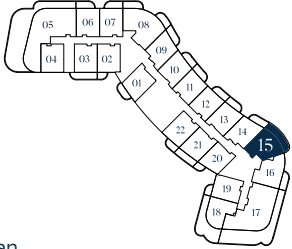

Key Plan

Disclaimer: All dimensions, materials and drawings are approximate. Information is subject to change without notice, at the developer's absolute discretion. The actual area may vary from the stated area. Drawings are not to scale. All images used are for illustrative purposes only and do not represent the actual size, features, specifications, fittings and furnishings. The developer reserves the right to make revisions/alterations, at the absolute discretion without any liability whatsoever.

2BHK - TYPE A

UNIT 211



1	Kitchen	2.4mx2.7m
2	Living	3.7mx5.9m
3	PWD Room	1.6mx1.9m
4	Bedroom -1	5.6mx5.2m
5	Bath -1	1.7mx2.6m
6	Dress -1	1.7mx2m
7	Bedroom -2	3.4mx3.7m
8	Bath -2	1.7mx2.7m
9	Dress -2	1.6mx2.7m
10	Laundry	1.6mx1.5m
11	Balcony	12.1mx2m

Suite Area	101.28 sq.m to	102.17 sq.m
	1090.17 sq.ftto	1099.75 sq.ft
Balcony Area	22.09 sq.m to	134.81 sq.m
	237.77 sq.ft to	1451.08 sq.ft
Total Area	124.05 sq.m to	236.09 sq.m
	1335.26 sq.ftto	2541.25 sq.ft

Level G , 1 , 2 , 3 , 4 , 5 , 6 , 7 , 8

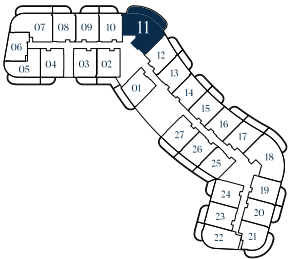

Key Plan

Disclaimer: All dimensions, materials and drawings are approximate. Information is subject to change without notice, at the developer's absolute discretion. The actual area may vary from the stated area. Drawings are not to scale. All images used are for illustrative purposes only and do not represent the actual size, features, specifications, fittings and furnishings. The developer reserves the right to make revisions/alterations, at the absolute discretion without any liability whatsoever.

2BHK - TYPE B

UNIT 207



1	Kitchen	2.5mx2.7m
2	Living	3.7mx5.7m
3	PWD Room	2mx1.3m
4	Bedroom -1	4.7mx3.8m
5	Bath -1	2.6mx1.6m
6	Dress -1	3.1mx1.6m
7	Bedroom -2	3.9mx4.2m
8	Bath -2	1.7mx2.6m
9	Balcony	11mx2m

Suite Area	87.85sq.m
	945.61 sq.ft
Balcony Area	11.2 sq.m to 22.57 sq.m
	120.56 sq.ft to 242.94 sq.ft
Total Area	99.05 sq.m to 110.42 sq.m
	1066.17 sq.ft to 1188.55 sq.ft

Level 1, 2, 3, 4

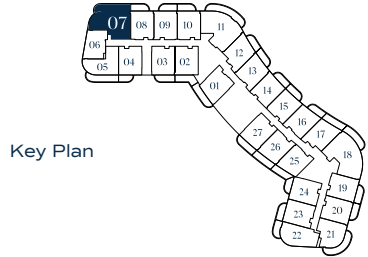

Key Plan

Disclaimer: All dimensions, materials and drawings are approximate. Information is subject to change without notice, at the developer's absolute discretion. The actual area may vary from the stated area. Drawings are not to scale. All images used are for illustrative purposes only and do not represent the actual size, features, specifications, fittings and furnishings. The developer reserves the right to make revisions/alterations, at the absolute discretion without any liability whatsoever.

2BHK - TYPE C

UNIT 714



1	Kitchen	2.5mx2.6m
2	Living	4.4mx7.5m
3	PWD Room	1.6mx1.9m
4	Bedroom -1	4.8mx5.7m
5	Bath -1	2.3mx2.7m
6	Dress -1	2.3mx2.4m
7	Bedroom -2	3.3mx5.3m
8	Bath -2	2mx3.1m
9	Balcony -1	6.6mx13.5m
10	Balcony -2	11.8mx2m

Suite Area	116.01 sq.m	
	1248.72 sq.ft	
Balcony Area	74.39 sq.m	to 114.12 sq.m
	800.73 sq.ft	to 1228.38 sq.ft
Total Area	190.4 sq.m	to 230.13 sq.m
	2049.45 sq.ft	to 2477.1 sq.ft

Level 7, 8

Key Plan

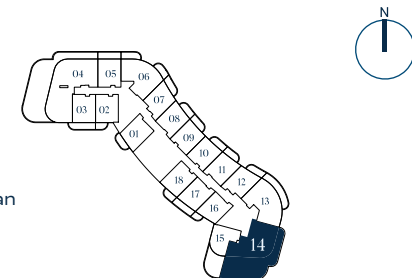

2BHK - TYPE D

UNIT 218



1	Kitchen	2.5mx2.7m
2	Living	3.8mx6m
3	PWD Room	1.5mx1.7m
4	Bedroom -1	6.6mx4.4m
5	Bath -1	1.9mx2.6m
6	Dress -1	1.9mx1.8m
7	Bedroom -2	3.4mx4m
8	Bath -2	1.7mx2.8m
9	Dress -2	1.6mx2.8m
10	Laundry	1.7mx1.7m
11	Balcony	8.1mx2m

Level 1, 2, 3, 4, 7, 8

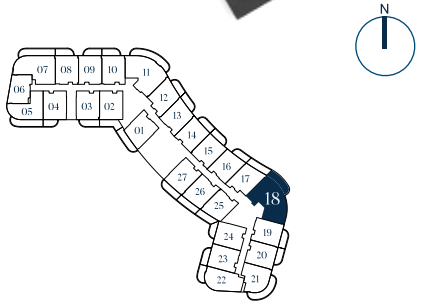

Key Plan

Suite Area	106.77 sq.m	to	107.48 sq.m
	1149.26 sq.ft	to	1156.91 sq.ft
Balcony Area	16.94 sq.m	to	34.14 sq.m
	182.34 sq.ft	to	367.48 sq.ft
Total Area	123.71 sq.m	to	140.92 sq.m
	1331.6 sq.ft	to	1516.85 sq.ft

Disclaimer: All dimensions, materials and drawings are approximate. Information is subject to change without notice, at the developer's absolute discretion. The actual area may vary from the stated area. Drawings are not to scale. All images used are for illustrative purposes only and do not represent the actual size, features, specifications, fittings and furnishings. The developer reserves the right to make revisions/alterations, at the absolute discretion without any liability whatsoever.

2BHK - TYPE E

UNIT 904



Level 9 , 10

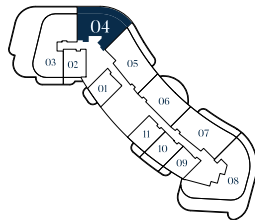

Key Plan

1	Kitchen	2.4m x 3.1m
2	Living	5.5m x 7.6m
3	PWD Room	1.5m x 2.3m
4	Bedroom -1	3.4m x 5m
5	Bath -1	1.7m x 2.7m
6	Dress -1	1.5m x 3.3m
7	Bedroom -2	3.8m x 5.3m
8	Bath -2	2.7m x 1.7m
9	Store	2.4m x 1.7m
10	Balcony -1	10.6m x 2m
11	Balcony -2	6.8m x 2m

Suite Area	108.22 sq.m
	1164.87 sq.ft
Balcony Area	34.97 sq.m to 35.56 sq.m
	376.41 sq.ft to 382.76 sq.ft
Total Area	143.19 sq.m to 143.78 sq.m
	1541.28 sq.ft to 1547.64 sq.ft

3BHK - TYPE A

UNIT 6006



1	Kitchen	3.1mx2.5m
2	Living	5.7mx4.6m
3	PWD Room	1.7mx1.7m
4	Bedroom -1	3.6mx5.2m
5	Bath -1	2mx2.9m
6	Dress -1	2mx2.6m
7	Bedroom -2	5.7mx3.6m
8	Bath -2	1.6mx2.5m
9	Bedroom -3	5.5mx3.4m
10	Bath -3	2.8mx1.7m
11	Dress -3	2.8mx1.6m
12	Maid Room	2.6mx2.5m
13	Bath -4	1.5mx1.5m
14	Laundry	1.3mx2.3m
15	Balcony -1	19.8mx4m
16	Balcony -2	6.3mx12.6m

Level G



Key Plan

Suite Area	143.49 sq.m
	1544.51 sq.ft
Balcony Area	159.5 sq.m
	1716.84 sq.ft
Total Area	302.99 sq.m
	3261.36 sq.ft

3BHK - TYPE B

UNIT 617



1	Kitchen	2.4mx3.5m
2	Living	3.6mx7.8m
3	PWD Room	1.3mx1.9m
4	Bedroom -1	4.1mx5.1m
5	Bath -1	2mx3.6m
6	Dress -1	1.5mx3.6m
7	Bedroom -2	4.4mx3.1m
8	Bath -2	2.4mx1.6m
9	Dress -2	3.5mx1.9m
10	Bedroom -3	3.5mx5.1m
11	Bath -3	2.6mx1.6m
12	Maid Room	2.5mx1.9m
13	Bath -4	1.9mx1.3m
14	Store	1.7mx1.6m
15	Balocony -1	12.8mx2m
16	Balcony -2	3.2mx12.8m

Level 5 , 6

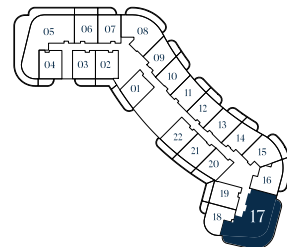

Key Plan



Suite Area	142.11 sq.m	to	142.12 sq.m
	1529.66 sq.ft	to	1529.77 sq.ft
Balcony Area	62.82 sq.m	to	94.37 sq.m
	676.19 sq.ft	to	1015.79 sq.ft
Total Area	204.94 sq.m	to	236.48 sq.m
	2205.96 sq.ft	to	2545.45 sq.ft

3BHK - TYPE C

UNIT 605

1	Kitchen	3.1m x 4.3m
2	Living	4m x 6.9m
3	PWD Room	2.3m x 1.4m
4	Bedroom -1	5.1m x 4.4m
5	Bath -1	3m x 2.8m
6	Dress -1	3.7m x 2.3m
7	Bedroom -2	5.3m x 3m
8	Bath -2	2.6m x 1.6m
9	Dress -2	1.8m x 1.6m
10	Bedroom -3	4.1m x 4.3m
11	Bath -3	1.6m x 2.6m
12	Dress -3	1.6m x 1.7m
13	Maid Room	2m x 2.4m
14	Bath -4	2m x 1.5m
15	Store	2m x 1.6m
16	Laundry	1m x 1.8m
17	Balcony -1	13.5m x 2m
18	Balcony -2	4.6m x 19.2m
19	Balcony -3	5.2m x 2m

Suite Area	166.71 sq.m
	1794.45 sq.ft
Balcony Area	102.75 sq.m to 135.59 sq.m
	1105.99 sq.ft to 1459.48 sq.ft
Total Area	269.46 sq.m to 302.3 sq.m
	2900.44 sq.ft to 3253.93 sq.ft



Level 5, 6

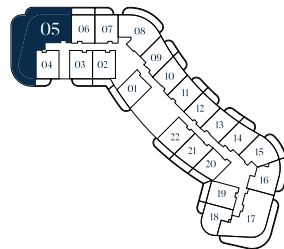

Key Plan



3BHK - TYPE D

UNIT 1006



1	Kitchen	2.4m x 2.7m
2	Living	3.7m x 5.7m
3	PWD Room	1.1m x 1.9m
4	Bedroom -1	3m x 4.1m
5	Bath -1	1.7m x 2.5m
6	Dress -1	3m x 1.6m
7	Bedroom -2	3.8m x 3.3m
8	Bath -2	2.6m x 1.5m
9	Bedroom -3	3.1m x 4.8m
10	Bath -3	1.7m x 2.5m
11	Maid Room	2m x 1.9m
12	Bath -4	2m x 1.3m
13	Balcony	14.1m x 3.2m

Level 9 , 10

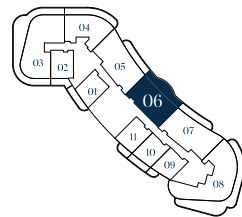

Key Plan

Suite Area	116.85 sq.m	
	1257.76 sq.ft	
Balcony Area	26.42 sq.m	to 35.1 sq.m
	284.38 sq.ft	to 377.81 sq.ft
Total Area	143.27 sq.m	to 151.95 sq.m
	1542.15 sq.ft	to 1635.58 sq.ft

3BHK - TYPE E

UNIT 1007



1	Kitchen	3m x 3m
2	Living	3.4m x 6.9m
3	PWD Room	2.1m x 1.5m
4	Bedroom -1	3.2m x 4.4m
5	Bath -1	2.2m x 2.4m
6	Dress -1	3.2m x 1.6m
7	Bedroom -2	3.4m x 4.4m
8	Bath -2	1.7m x 2.6m
9	Dress -2	1.6m x 2.5m
10	Bedroom -3	3.4m x 4.8m
11	Bath -3	1.7m x 2.6m
12	Dress -3	1.6m x 2.7m
13	Maid Room	2.4m x 4.1m
14	Bath -4	1.3m x 1.7m
15	Store	1.3m x 1.5m
16	Laundry	1m x 1.5m
17	Balcony	11.9m x 2m

Level 9 , 10

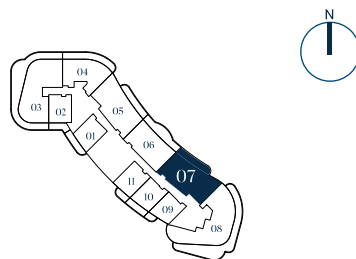

Key Plan

Suite Area	144.16 sq.m	to	145.12 sq.m
	1551.73 sq.ft	to	1562.06 sq.ft
Balcony Area	23.71 sq.m	to	28.43 sq.m
	255.21 sq.ft	to	306.02 sq.ft
Total Area	167.87 sq.m	to	173.55 sq.m
	1806.94 sq.ft	to	1868.08 sq.ft

3BHK - TYPE F

UNIT 804



1	Kitchen	3.1mx3.2m
2	Living	5.8mx6.1m
3	PWD Room	2.4mx1.6m
4	Bedroom -1	4.5mx5.6m
5	Bath -1	2.6mx2.8m
6	Dress -1	2.4mx2.1m
7	Bedroom -2	6.1mx3.8m
8	Bath -2	2.9mx1.8m
9	Dress -2	2.2mx1.8m
10	Bedroom -3	5.1mx4.6m
11	Bath -3	2.8mx2.3m
12	Dress -3	2.8mx2.1m
13	Maid Room	2.6mx2.1m
14	Bath -4	1.4mx1.8m
15	Laundry	1.2mx1.8m
16	Store	1.4mx1m
17	Balcony -1	12.2mx2m
18	Balcony -2	3mx13.8m

Level 7, 8

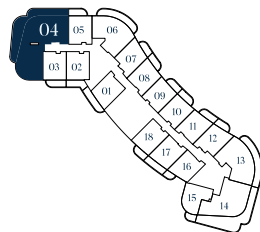

Key Plan



Suite Area	191.62 sq.m	
	2062.58 sq.ft	
Balcony Area	63.83 sq.m	to 156.58 sq.m
	687.06 sq.ft	to 1685.41 sq.ft
Total Area	255.45 sq.m	to 348.2 sq.m
	2749.64 sq.ft	to 3747.99 sq.ft

3BHK - TYPE G

UNIT 1105



1	Kitchen	2.5m x 2.6m
2	Living	8.1m x 7.8m
3	PWD Room	2.4m x 1.4m
4	Bedroom -1	4.5m x 4.9m
5	Bath -1	2.3m x 3m
6	Dress -1	2.3m x 2.5m
7	Bedroom -2	5.1m x 3.4m
8	Bath -2	1.7m x 2.8m
9	Dress -2	1.4m x 1.9m
10	Bedroom -3	5m x 4m
11	Bath -3	2.7m x 1.6m
12	Maid Room	2.4m x 3.7m
13	Bath -4	1.3m x 1.6m
14	Laundry	1.3m x 1m
15	Balcony -1	9.4m x 2m
16	Balcony -2	13.5m x 2m
17	Balcony -3	5.9m x 18.4m

Level 11

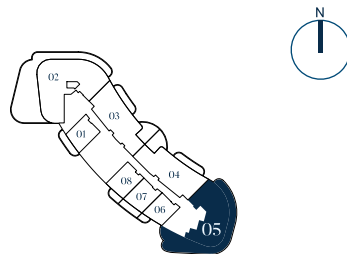

Key Plan

Suite Area	167.38 sq.m
	1801.66 sq.ft
Balcony Area	118.33 sq.m
	1273.69 sq.ft
Total Area	285.71 sq.m
	3075.36 sq.ft

3BHK - TYPE H

UNIT 1003



1	Kitchen	3m x 3.7m
2	Living	10.8m x 5.2m
3	PWD Room	1.4m x 2m
4	Bedroom -1	3.5m x 6.2m
5	Bath -1	2m x 4m
6	Dress -1	2.3m x 2.2m
7	Bedroom -2	3.3m x 4.1m
8	Bath -2	1.7m x 1.9m
9	Dress -2	1.7m x 1.6m
10	Bedroom -3	4.6m x 4.4m
11	Bath -3	1.6m x 2.6m
12	Maid Room	2.4m x 2.7m
13	Bath -4	1.8m x 1.5m
14	Laundry	1.8m x 1.6m
15	Balcony -1	10.4m x 2m
16	Balcony -2	3.9m x 19m
17	Balcony -3	9.4m x 2m

Level 9, 10

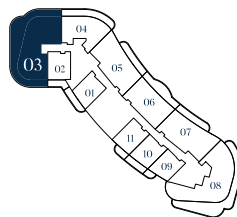

Suite Area	176.36 sq.m	to	176.88 sq.m
	1898.32 sq.ft	to	1903.92 sq.ft
Balcony Area	103.53 sq.m	to	189.32 sq.m
	1114.39 sq.ft	to	2037.82 sq.ft
Total Area	280.41 sq.m	to	365.68 sq.m
	3018.31 sq.ft	to	3936.15 sq.ft

3BHK - TYPE I

UNIT 1203

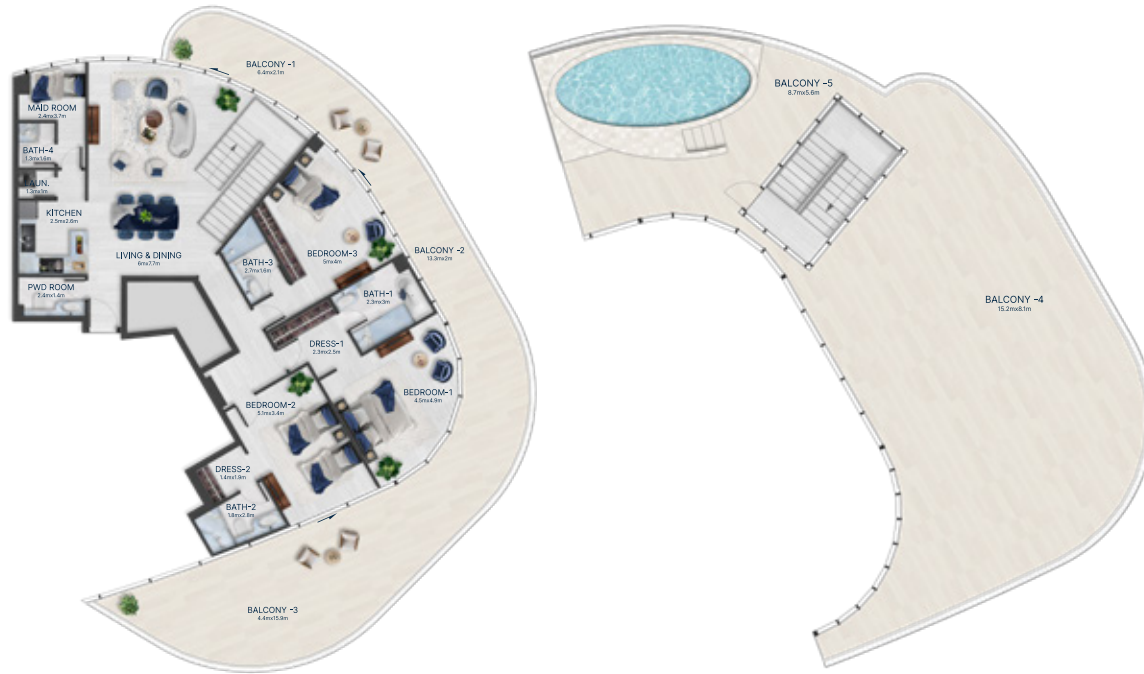

LOWER FLOOR PLAN

UPPER FLOOR PLAN

Level 12

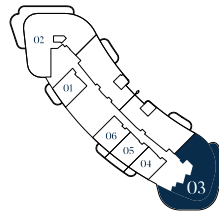

1	Kitchen	2.5m x 2.6m
2	Living	6m x 7.7m
3	PWD Room	2.4m x 1.4m
4	Bedroom -1	4.5m x 4.9m
5	Bath -1	2.3m x 3m
6	Dress -1	2.3m x 2.5m
7	Bedroom -2	5.1m x 3.4m
8	Bath -2	1.8m x 2.8m
9	Dress -2	1.4m x 1.9m
10	Bedroom -3	5m x 4m
11	Bath -3	2.7m x 1.6m
12	Maid Room	2.4m x 3.7m
13	Bath -4	1.3m x 1.6m
14	Laundry	1.3m x 1m
15	Balcony -1	6.4m x 2.1m
16	Balcony -2	13.3m x 2m
17	Balcony -3	4.4m x 15.9m
18	Balcony -4	15.2m x 8.1m
19	Balcony -5	8.7m x 5.6m

Suite Area	180.47 sq.m
	1942.56 sq.ft
Balcony Area	244.67 sq.m
	2633.61 sq.ft
Total Area	425.14 sq.m
	4576.17 sq.ft

3BHK - TYPE J

UNIT 1008



1	Kitchen	2.9mx2.6m
2	Living	7.9mx7.7m
3	PWD Room	1.7mx1.4m
4	Bedroom -1	4.4mx6.5m
5	Bath -1	2.3mx3.8m
6	Dress -1	3.1mx3.8m
7	Bedroom -2	4.5mx5.6m
8	Bath -2	2mx2.7m
9	Dress -2	1.5mx1.7m
10	Bedroom -3	3.2mx5.7m
11	Bath -3	1.8mx2.9m
12	Dress -3	1.8mx2.6m
13	Store	2.3mx1.4m
14	Laundry	2.9mx1.4m
15	Balcony -1	7.9mx2m
16	Balcony -2	13.5mx2m
17	Balcony -3	4.1mx15.1m

Level 9 , 10

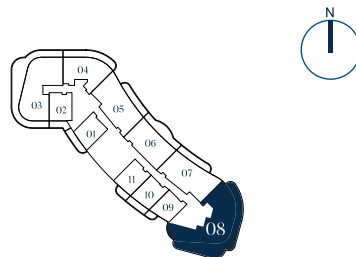

Key Plan

Suite Area	186.65 sq.m	
	2009.08 sq.ft	
Balcony Area	97.67 sq.m	to 133.49 sq.m
	1051.31 sq.ft to 1436.87 sq.ft	
Total Area	284.32 sq.m	to 320.14 sq.m
	3060.4 sq.ft to 3445.96 sq.ft	

4BHK - PENTHOUSE

UNIT 1102



Level 11

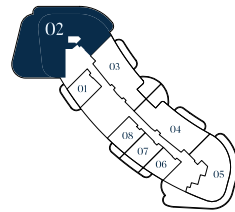

Key Plan

1	Kitchen	2.6mx3.7m
2	Living	10.4mx7.1m
3	PWD Room	1.4mx2.7m
4	Bedroom -1	6.3mx4.9m
5	Bath -1	3mx2.4m
6	Dress -1	3mx2.3m
7	Bedroom -2	5mx5.9m
8	Bath -2	2mx2.5m
9	Dress -2	2mx3.3m
10	Bedroom -3	4.1mx3.5m
11	Bath -3	2.5mx1.7m
12	Dress -3	2.5mx1.7m
13	Bedroom -4	4.6mx4.4m
14	Bath -4	1.6mx2.6m
15	Dress -4	1.6mx1.7m
16	Maid Room	2.5mx3.8m
17	Bath -5	1.4mx1.6m
18	Laundry	1.4mx1.2m
19	Balcony -1	8.8mx18.7m
20	Balcony -2	17.8mx2m
21	Balcony -3	7.9mx2m

Suite Area 253.66 sq.m

2730.37 sq.ft

Balcony Area 185.57 sq.m

1997.46 sq.ft

Total Area 439.23 sq.m

4727.83 sq.ft

4BHK - PENTHOUSE DUPLEX

UNIT 1202



LOWER FLOOR PLAN



UPPER FLOOR PLAN

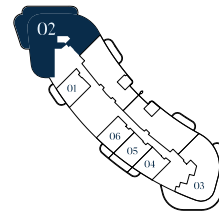

Key Plan



1	Kitchen	2.6mx3.7m
2	Living	8.6mx7.7m
3	PWD Room	1.4mx2.1m
4	Bedroom -1	6.3mx4.9m
5	Bath -1	3mx2.4m
6	Dress -1	3mx2.3m
7	Bedroom -2	4.8mx5.9m
8	Bath -2	2.2mx2.8m
9	Dress -2	2.2mx3m
10	Bedroom -3	4.1mx3.5m
11	Bath -3	2.6mx1.7m
12	Dress -3	2.6mx1.7m
13	Bedroom -4	4.6mx4.4m
14	Bath -4	1.7mx2.6m
15	Dress -4	1.7mx1.7m
16	Maid Room	2.5mx3.8m
17	Bath -5	1.4mx1.6m
18	Laundry	1.4mx1.2m
19	Balcony -1	2.7mx10.2m
20	Balcony -2	15.9mx2m
21	Balcony -3	12.1mx6.8m
22	Balcony -4	10.1mx5.6m
23	Balcony -5	3.6mx17.9m

Suite Area	266.74 sq.m
	2871.17 sq.ft
Balcony Area	244.41 sq.m
	2630.81 sq.ft
Total Area	511.15 sq.m
	5501.97 sq.ft

4BHK - PENTHOUSE TRIPLEX - 1 UNIT 1103

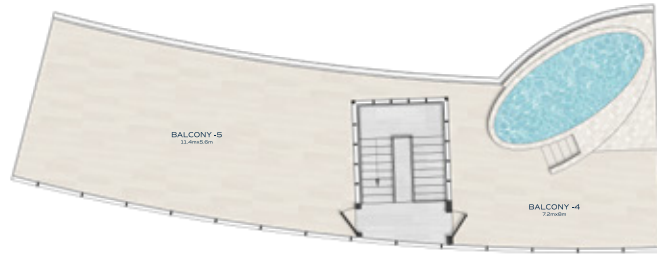

ROOF FLOOR PLAN



UPPER FLOOR PLAN



LOWER FLOOR PLAN

Level 11

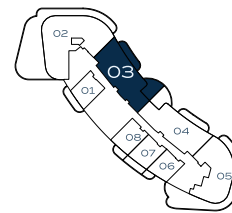

Key Plan



Suite Area	353.78 sq.m
	3808.06 sq.ft
Balcony Area	190.17 sq.m
	2046.97 sq.ft
Total Area	543.95 sq.m
	5855.03 sq.ft

1	Kitchen	3.4mx3.4m
2	Living	10.3mx8.4m
3	Family Living	6.4mx4.8m
4	PWD Room	1.4mx2.3m
5	Wash Room	1.9mx1.8m
6	Bedroom -1	6.9mx5.1m
7	Bath -1	2.1mx3.2m
8	Dress -1	2.5mx2.7m
9	Bedroom -2	6.5mx5.1m
10	Bath -2	2.1mx3.2m
11	Dress -2	2.5mx3.2m
12	Bedroom -3	3.8mx5.1m
13	Bath -3	2.6mx1.8m
14	Dress -3	1.6mx1.8m
15	Bedroom -4	3.8mx3.8m
16	Bath -4	1.8mx2.6m
17	Dress -4	1.8mx2.6m
18	Maid Room	2.6x2.1m
19	Bath -5	2mx1.7m
20	Dress -5	2.1mx1.2m
21	Store	2.5mx1.4m
22	Laundry	1mx1.4m
23	Balcony -1	9.9mx2m
24	Balcony -2	5.5mx6.3m
25	Balcony -3	7.9mx2m
26	Balcony -4	7.2mx8m
27	Balcony -5	11.4mx5.6m

4BHK - PENTHOUSE TRIPLEX - 2 UNIT 1104

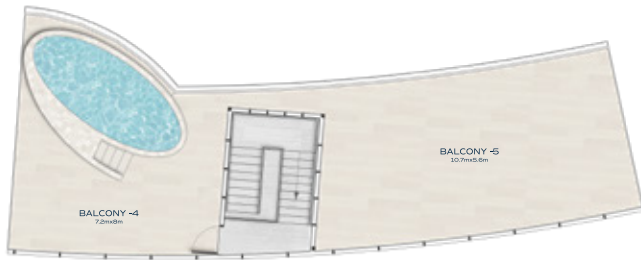

ROOF FLOOR PLAN



UPPER FLOOR PLAN



LOWER FLOOR PLAN

Level 11

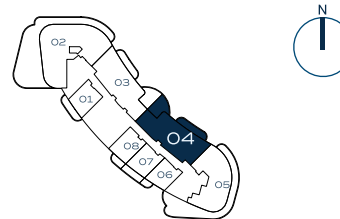

Key Plan

Suite Area	347.37 sq.m
	3739.06 sq.ft
Balcony Area	173.32 sq.m
	1865.6 sq.ft
Total Area	520.69 sq.m
	5604.66 sq.ft

1	Kitchen	3.4m x 3.4m
2	Living	10.3m x 8.4m
3	Family Living	6.4m x 4.8m
4	PWD Room	1.4m x 2.3m
5	Wash Room	1.9m x 1.8m
6	Bedroom -1	6.9m x 5.1m
7	Bath -1	2.1m x 3.2m
8	Dress -1	2.5m x 2.7m
9	Bedroom -2	6.5m x 5.1m
10	Bath -2	2.1m x 3.2m
11	Dress -2	2.5m x 3.2m
12	Bedroom -3	3.8m x 5.1m
13	Bath -3	2.6m x 1.8m
14	Dress -3	2.6m x 1.8m
15	Bedroom -4	3.8m x 3.8m
16	Bath -4	1.8m x 2.6m
17	Dress -4	1.9m x 2.6m
18	Maid Room	2.6 x 2.1m
19	Bath -5	2m x 1.7m
20	Dress -5	2.1m x 1.4m
21	Store	2.5m x 2m
22	Laundry	1m x 1.4m
23	Balcony -1	10.3m x 2m
24	Balcony -2	5.5m x 6.3m
25	Balcony -3	7.5m x 2m
26	Balcony -4	7.2m x 8m
27	Balcony -5	10.7m x 5.6m

RESTAURANT

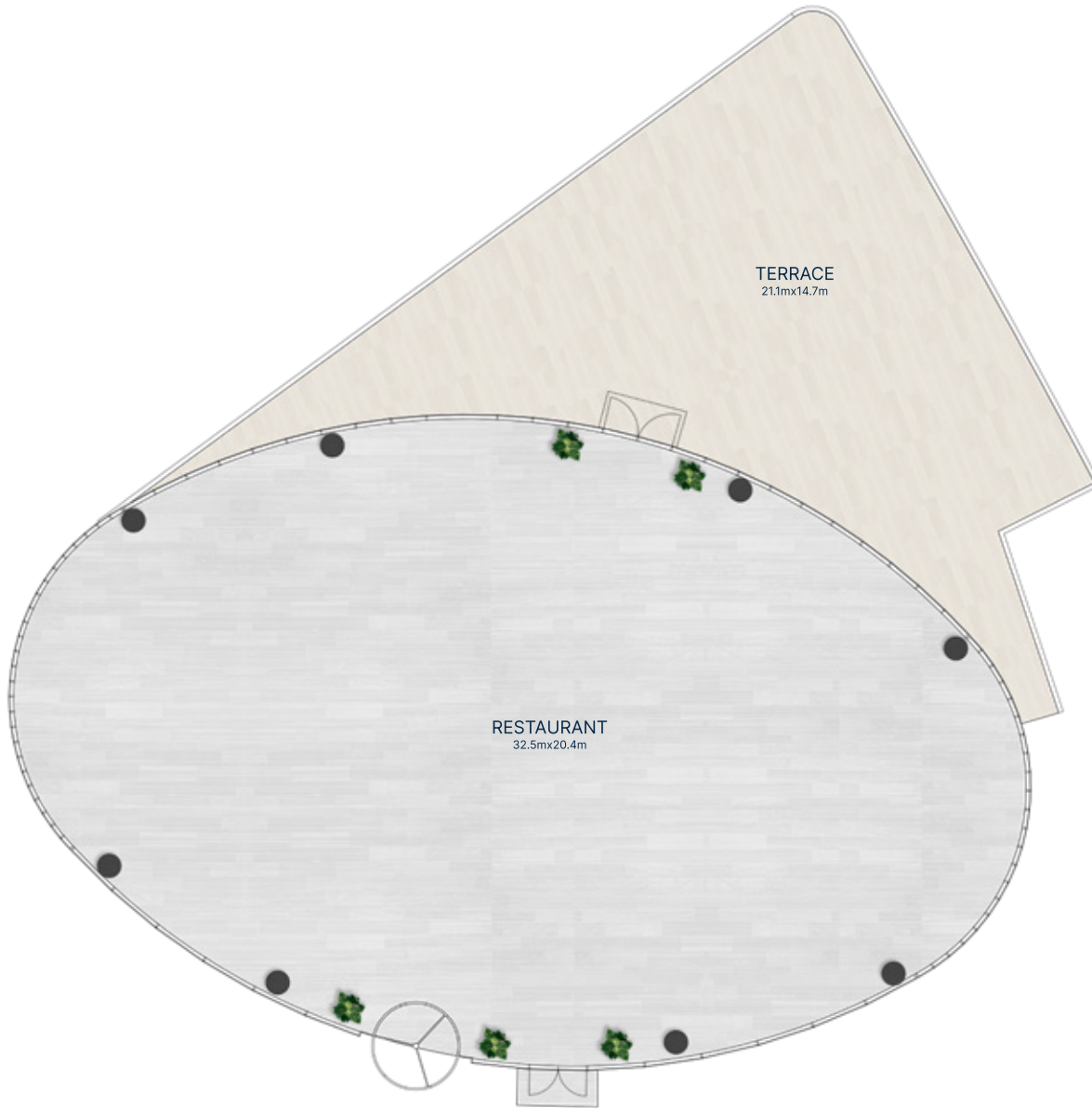

1	Restaurant	32.5mx20.4m
2	Terrace	21.1mx14.7m

Suite Area	524.46 sq.m
	5645.24 sq.ft
Balcony Area	237.8 sq.m
	2559.66 sq.ft
Total Area	762.26 sq.m
	8204.9 sq.ft

Level G



Key Plan

The background of the slide features a close-up, low-angle shot of a palm tree frond. The frond is the central focus, with its numerous leaflets radiating from a central rachis. The lighting is dramatic, with the frond appearing to glow from within, creating a strong contrast against the deep blue background. The overall effect is a sense of depth and texture, with the frond's structure clearly visible despite the slight blur in some areas.

FLOOR PLANS



BASEMENT 1 FLOOR *plan*



1 ACCESS TO UPPER FLOOR

2 ACCESS TO LOWER FLOOR

3 LIFT

4 LIFT LOBBY

5 PARKING



BASEMENT 2 FLOOR *plan*



- 1 RAMP UP TO BASEMENT 1
- 2 RAMP DOWN FROM BASEMENT 1
- 3 LIFT
- 4 LIFT LOBBY
- 5 PARKING
- 6 PUMP ROOM



GROUND FLOOR *plan*



- 1 ENTRY & EXIT
- 2 MAIN ENTRANCE
- 3 RECEPTION
- 4 LOUNGE
- 5 LIFT
- 6 LIFT LOBBY
- 7 DROP OFF
- 8 LOADING & UNLOADING
- 9 SITTING AREA
- 10 KIDS PLAY AREA
- 11 ACCESS TO LOWER PARKING
- 12 RESTAURANT & OUTDOOR SITTING AREA



FIRST FLOOR *plan*



1 GYM

2 POOL

3 POOL DECK

4 LIFT

5 LIFT LOBBY

6 CAFE

7 OUTDOOR CAFE

8 SWIMMING POOL & GYM LOBBY

9 KIDS PLAY AREA

10 WOMEN'S SHOWER

11 MEN'S SHOWER

12 POD BATH



SECOND FLOOR *plan*



- 1BHK - TYPE A
- 1BHK - TYPE B
- 1BHK - TYPE C
- 1BHK - TYPE D
- 1BHK - TYPE E
- 1BHK - TYPE F
- 1BHK - TYPE G
- 2BHK - TYPE A
- 2BHK - TYPE B
- 2BHK - TYPE D

Disclaimer: All dimensions, materials and drawings are approximate. Information is subject to change without notice, at the developer's absolute discretion. The actual area may vary from the stated area. Drawings are not to scale. All images used are for illustrative purposes only and do not represent the actual size, features, specifications, fittings and furnishings. The developer reserves the right to make revisions/alterations, at the absolute discretion without any liability whatsoever.



THIRD FLOOR *plan*



- 1BHK - TYPE A
- 1BHK - TYPE B
- 1BHK - TYPE C
- 1BHK - TYPE D
- 1BHK - TYPE E
- 1BHK - TYPE F
- 1BHK - TYPE G
- 2BHK - TYPE A
- 2BHK - TYPE B
- 2BHK - TYPE D

Disclaimer: All dimensions, materials and drawings are approximate. Information is subject to change without notice, at the developer's absolute discretion. The actual area may vary from the stated area. Drawings are not to scale. All images used are for illustrative purposes only and do not represent the actual size, features, specifications, fittings and furnishings. The developer reserves the right to make revisions/alterations, at the absolute discretion without any liability whatsoever.



FOURTH FLOOR *plan*



- 1BHK - TYPE A
- 1BHK - TYPE B
- 1BHK - TYPE C
- 1BHK - TYPE D
- 1BHK - TYPE E
- 1BHK - TYPE F
- 1BHK - TYPE G
- 2BHK - TYPE A
- 2BHK - TYPE B
- 2BHK - TYPE D

Disclaimer: All dimensions, materials and drawings are approximate. Information is subject to change without notice, at the developer's absolute discretion. The actual area may vary from the stated area. Drawings are not to scale. All images used are for illustrative purposes only and do not represent the actual size, features, specifications, fittings and furnishings. The developer reserves the right to make revisions/alterations, at the absolute discretion without any liability whatsoever.



FIFTH FLOOR *plan*



- 1BHK - TYPE A
- 1BHK - TYPE B
- 1BHK - TYPE C
- 1BHK - TYPE H
- 1BHK - TYPE I
- 1BHK - TYPE J
- 2BHK - TYPE A
- 3BHK - TYPE B
- 3BHK - TYPE C

Disclaimer: All dimensions, materials and drawings are approximate. Information is subject to change without notice, at the developer's absolute discretion. The actual area may vary from the stated area. Drawings are not to scale. All images used are for illustrative purposes only and do not represent the actual size, features, specifications, fittings and furnishings. The developer reserves the right to make revisions/alterations, at the absolute discretion without any liability whatsoever.



SIXTH FLOOR *plan*



- 1BHK - TYPE A
- 1BHK - TYPE B
- 1BHK - TYPE C
- 1BHK - TYPE H
- 1BHK - TYPE I
- 1BHK - TYPE J
- 2BHK - TYPE A
- 3BHK - TYPE B
- 3BHK - TYPE C

Disclaimer: All dimensions, materials and drawings are approximate. Information is subject to change without notice, at the developer's absolute discretion. The actual area may vary from the stated area. Drawings are not to scale. All images used are for illustrative purposes only and do not represent the actual size, features, specifications, fittings and furnishings. The developer reserves the right to make revisions/alterations, at the absolute discretion without any liability whatsoever.



SEVENTH FLOOR *plan*



● 1BHK - TYPE A

● 1BHK - TYPE B

● 1BHK - TYPE C

● 1BHK - TYPE D

● 2BHK - TYPE A

● 2BHK - TYPE B

● 2BHK - TYPE C

● 2BHK - TYPE D



EIGHTH FLOOR *plan*



● 1BHK - TYPE A

● 1BHK - TYPE B

● 1BHK - TYPE C

● 1BHK - TYPE D

● 2BHK - TYPE A

● 2BHK - TYPE B

● 2BHK - TYPE C

● 3BHK - TYPE F



NINTH FLOOR *plan*

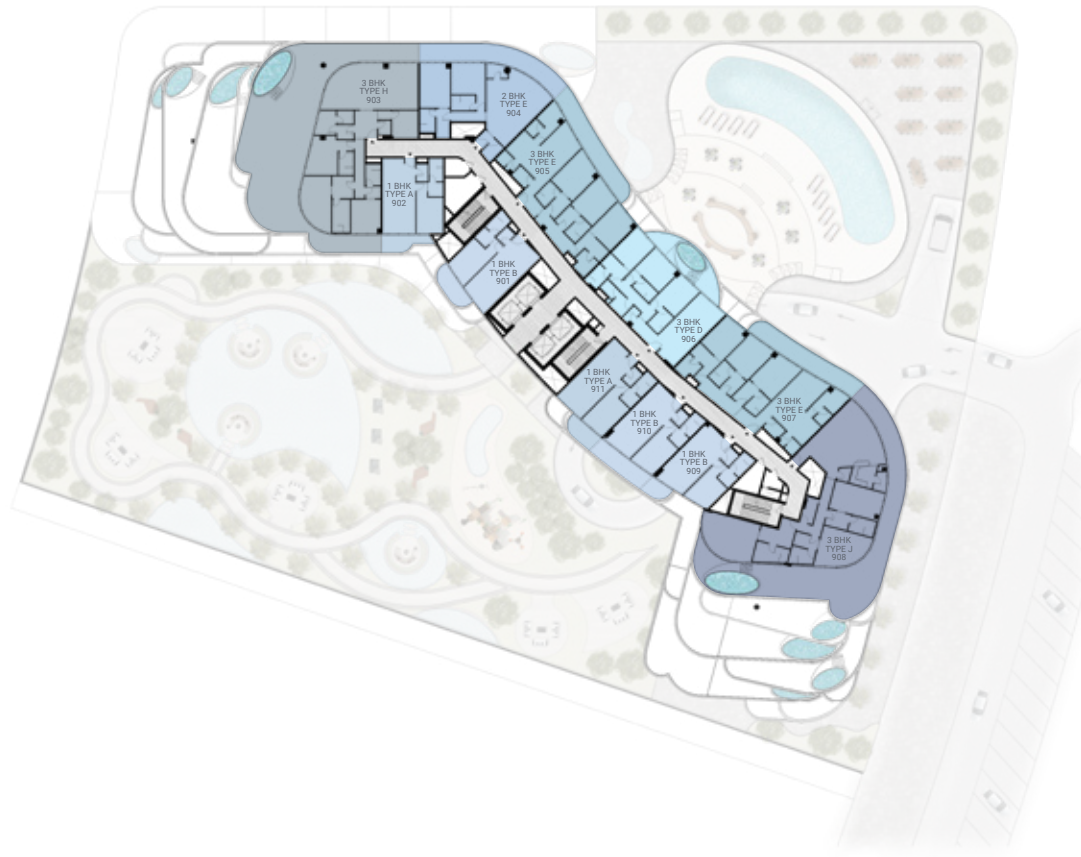

● 1BHK - TYPE A

● 1BHK - TYPE B

● 2BHK - TYPE E

● 3BHK - TYPE H

● 3BHK - TYPE E

● 3BHK - TYPE J

● 3BHK - TYPE G

● 3BHK - TYPE D



TENTH FLOOR *plan*

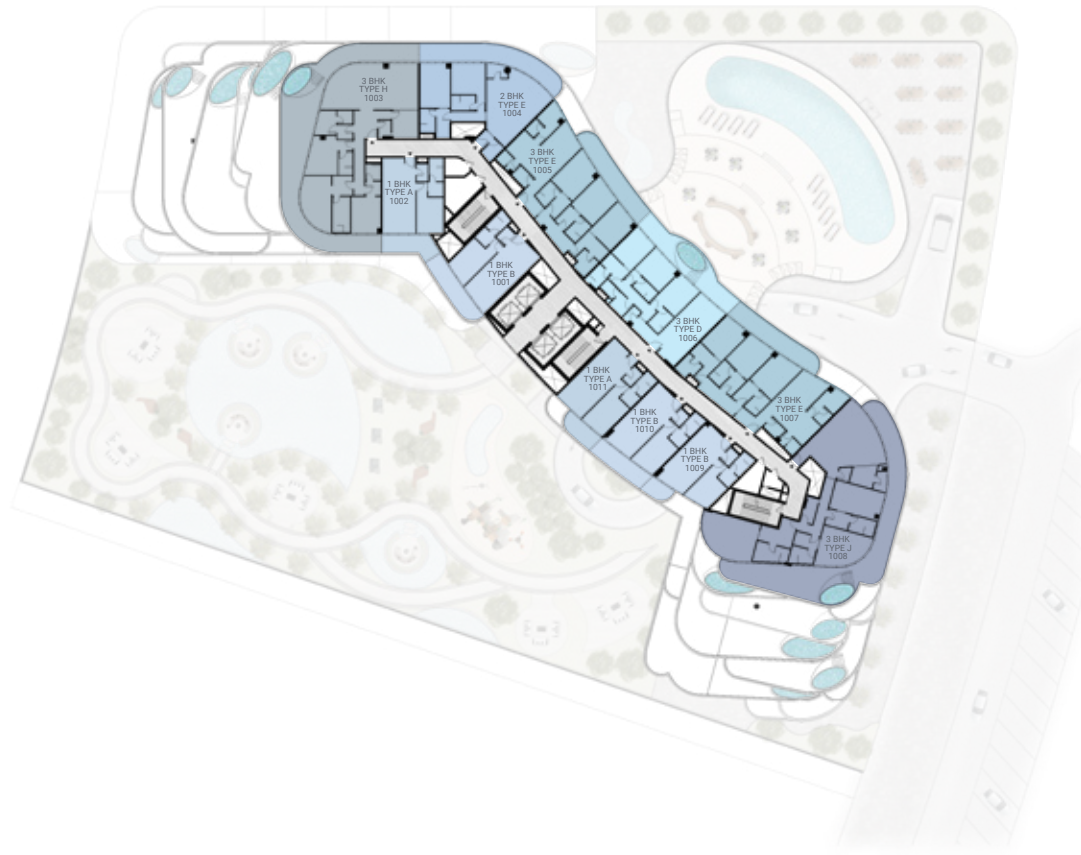

● 1BHK - TYPE A

● 1BHK - TYPE B

● 2BHK - TYPE E

● 3BHK - TYPE H

● 3BHK - TYPE E

● 3BHK - TYPE J

● 3BHK - TYPE G

● 3BHK - TYPE D



ELEVENTH FLOOR *plan*



- 1BHK - TYPE A
- 1BHK - TYPE B
- 3BHK - TYPE G
- 4BHK - TYPE A
- PENTHOUSE 1
- PENTHOUSE 2

Disclaimer: All dimensions, materials and drawings are approximate. Information is subject to change without notice, at the developer's absolute discretion. The actual area may vary from the stated area. Drawings are not to scale. All images used are for illustrative purposes only and do not represent the actual size, features, specifications, fittings and furnishings. The developer reserves the right to make revisions/alterations, at the absolute discretion without any liability whatsoever.



TWELFTH FLOOR *plan*

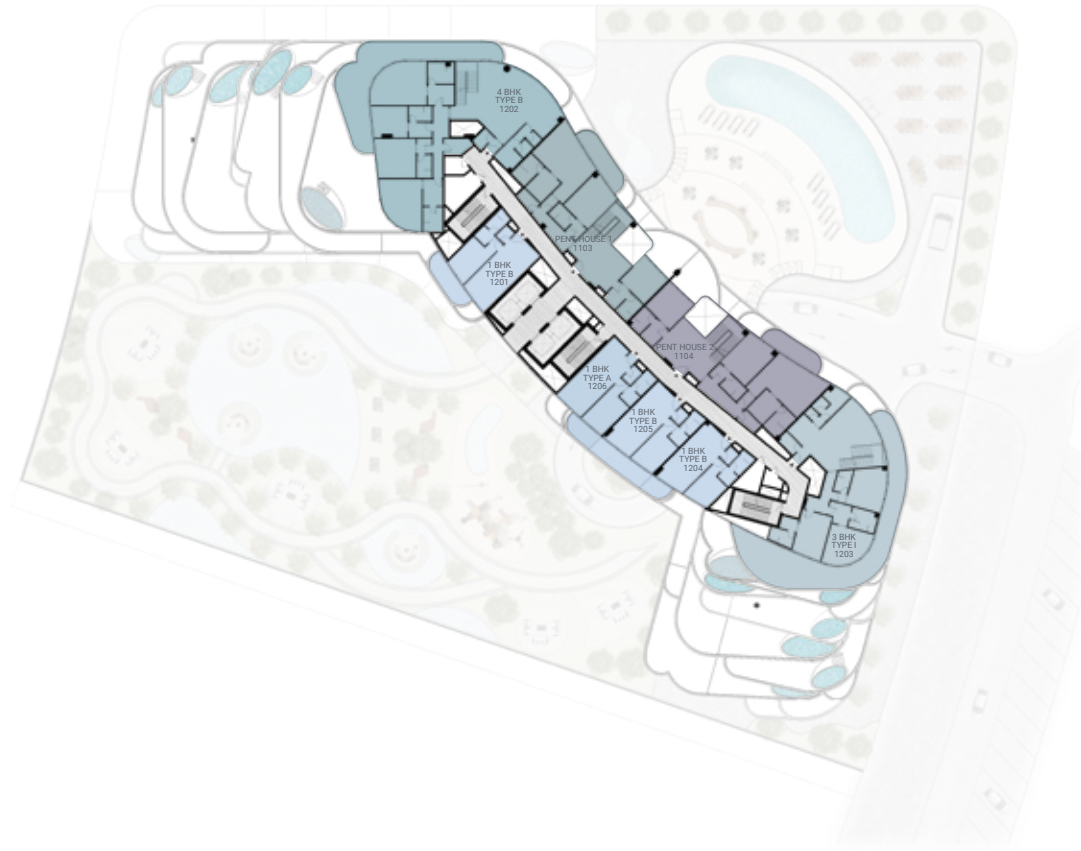

- 1BHK - TYPE A
- 1BHK - TYPE B
- 3BHK - TYPE I
- 4BHK - TYPE B
- PENTHOUSE 1
- PENTHOUSE 2

Disclaimer: All dimensions, materials and drawings are approximate. Information is subject to change without notice, at the developer's absolute discretion. The actual area may vary from the stated area. Drawings are not to scale. All images used are for illustrative purposes only and do not represent the actual size, features, specifications, fittings and furnishings. The developer reserves the right to make revisions/alterations, at the absolute discretion without any liability whatsoever.



ROOF FLOOR *plan*

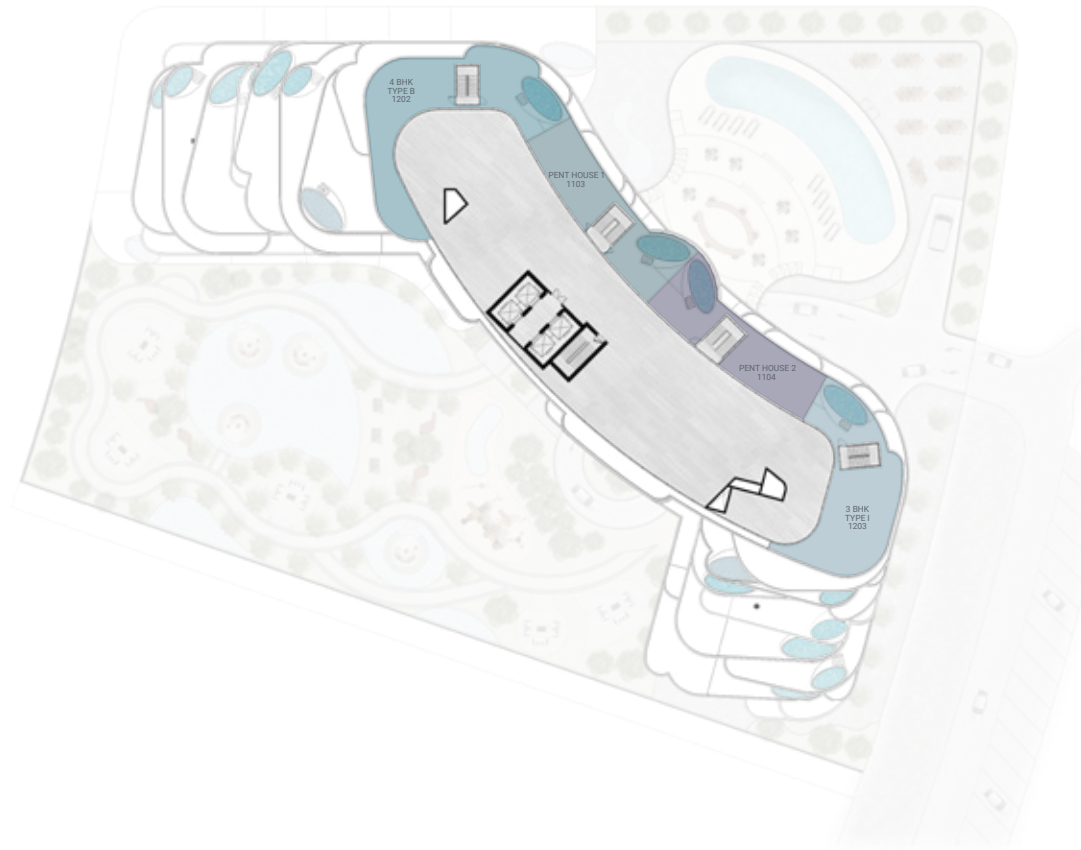

● 3BHK - TYPE I

● 4BHK - TYPE B

● PENTHOUSE 1

● PENTHOUSE 2



BNW

BNW DEVELOPMENTS
بي ان دبليو للتطوير العقاري

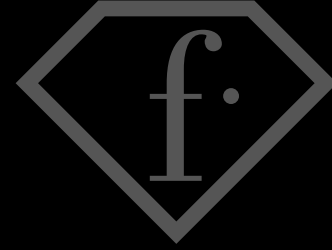

fashiontv

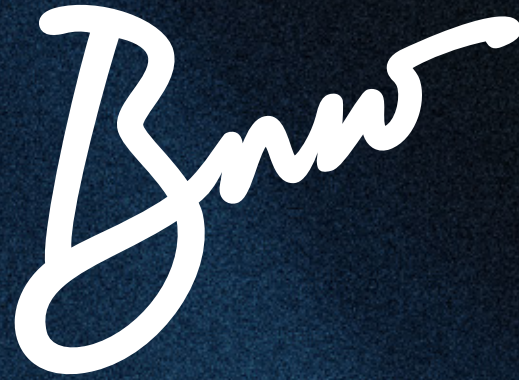

BNW DEVELOPMENTS
بي ان دبليو للتطوير العقاري

24th & 33rd Floor, Ubra Tower, Business Bay, Dubai, UAE

☎ 800BNWUAE

🌐 BNW.AE

✉ INFO@BNW.AE